

**PARTS FOR MODEL 685**

RECOMMENDED SPARE PARTS		
QTY.	PART NO.	ITEM
1	698	Stitch Counter
1	691	Reed Switch
1	650A	Magnet
1	697	Solenoid Valve
1	683	Air Cylinder
1	611	Overrunning Clutch
1	613	Auxiliary Brake
2	640D	Clutch/Brake Disc W / Facing
1	625C	High Speed Clutch Disc W / Facing

# 685 TRIP/GATE ASSY. & FEED ROLL LIFT ADJUSTER

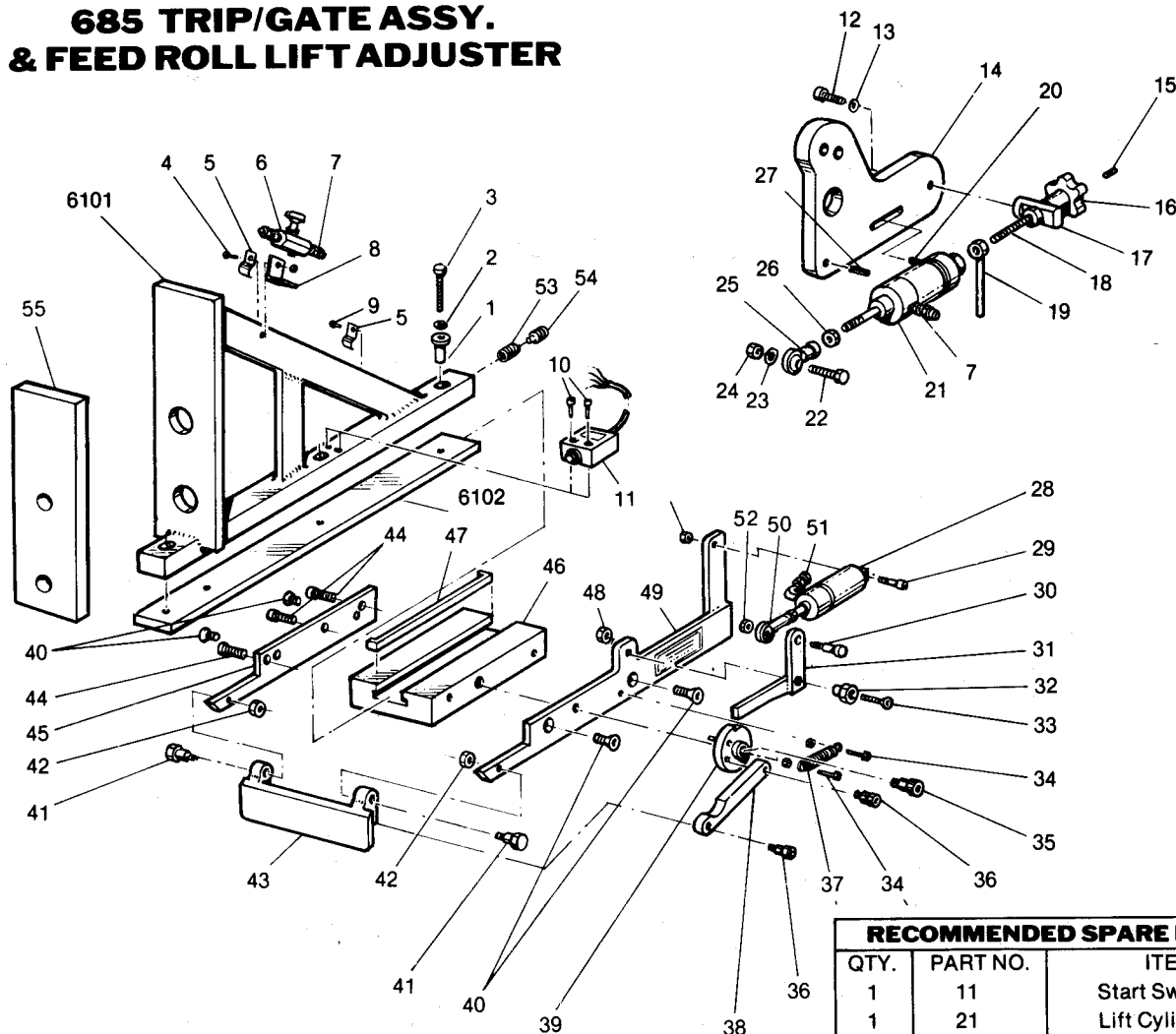

RECOMMENDED SPARE PARTS		
QTY.	PART NO.	ITEM
1	11	Start Switch
1	21	Lift Cylinder
1	28	Latch Cylinder

6101	TRIP FRAME	18	ADJUSTING ROD	37	SPRING
6102	SLIDE RAIL	19	LOCK HANDLE	38	LINK
1 (4)	SPACER	20	SPRING PIN	39	LATCH CAM
2 (4)	LOCK WASHER	21	LIFT CYLINDER	40 (4)	SCREWS
3 (4)	SCREW	22	SCREW	41 (2)	SHOULDER SCREW
4	SCREW	23	LOCK WASHER	42 (2)	JAM NUT
5	CABLE CLAMP	24	NUT	43	TRIP GATE
6	RESTRICTOR VALVE	25	ROD END—TF-7	44	LOCK SCREWS
7 (3)	POLY-FLO FITTING	26	JAM NUT	45	SIDE RAIL
8	BRACKET	27	SPRING PIN	46	SLIDE BLOCK
9	SCREW	28	LATCH CYLINDER	47	KEY
10	SCREW	29	SCREW	48	NUT
11	MICRO SWITCH—OCT-35	30	SCREW	49	SIDE RAIL
12	SCREW	31	LATCH	50	ROD END—TF-5
13	LOCK WASHER	32	LATCH ECCENTRIC	51	POLY-FLO FITTING
14	LIFT PLATE	33	SCREW	52	NUT
15	SET SCREW	34 (2)	SCREW	53	SPRING
16	KNOB	35	SHOULDER SCREW	54	SPRING ADJ. SCREW
17	GUIDE	36	SHOULDER SCREW	55	SPACER PLATE



**CRITTENDEN CONVERSION CORPORATION**

600	TOP FEED ROLL SHAFT	630	CRANKSHAFT	670	AUXILIARY BRAKE GUARD
601	TOP FEED ROLL SPROCKET	631	FLYWHEEL SPACER	673	BEARING SUPPORT
602	TOP UNIVERSAL JOINT	632	FLYWHEEL SPACER SCREWS	674	BELL CRANK JACK SHAFT SUPPORT
603	TOP JACK SHAFT	635	FLYWHEEL ASSY. COMPLETE	675	BASE PLATE
604	REVERSE GEAR SHAFT	635A	SPROCKET	676	SHAFT
605	TOP REVERSE GEAR	635B	BEARING—SL-15	677	SHAFT
606	BOTTOM REVERSE GEAR	635C	SNAP RING	678	SCREW
607	STEP FEED SHAFT	635D	THRUST BEARING—E-8	679	SCREW
608	BOTTOM UNIVERSAL JOINT	635F	FLYWHEEL	680	TURNBUCKLE ASSEMBLY COMPLETE
609	BOTTOM JACK SHAFT	640	CLUTCH AND BRAKE ASSY. COMPLETE	683	AIR CYLINDER
610	BOTTOM FEED ROLL SHAFT	640A	CLUTCH AND BRAKE SLEEVE	686	ROD END
611	OVERRUNNING CLUTCH	640B	COLLAR	687	CLEVIS
611A	OVERRUNNING CLUTCH KEY	640C	THRUST BEARING—E-25	687A	CLEVIS PIN
612	AUXILIARY BRAKE HUB	640D	CLUTCH AND BRAKE DISC	690	TRIP LATCH PADDLE
612A	AUXILIARY BRAKE DISC	642	BRAKE PLATE	691	REED SWITCH
613	AUXILIARY BRAKE	643	V-BELT	692	REED SWITCH CLAMP
614	AUXILIARY BRAKE MOUNT	644	BUSHING	693	LOCK-WASHER
615	SPROCKET	645	SHEAVE	694	SCREW
616	HIGH SPEED SHAFT	650	DISC	695	CHAIN # 40
617	SCREW	650A	MAGNET	696	BEARING SF-22 (NOT SHOWN) )
618	WASHER	655	SHAFT	697	SOL. VALVE -B02 (NOT SHOWN)!
619	THRUST BEARING—E-9	656	BELL CRANK	698	STITCH COUNTER (NOT SHOWN) (SPECIFY TYPE)
620	LOCK COLLAR	656A(2)	BELL CRANK BUSHING	OC1-1	HIGH SPEED CLUTCH ARM
621	KEY	658	SPACE LEVER	OC1-2	CLUTCH/BRAKE ARM
622	LOCK COLLAR	658A	BUSHING	OC1-3	CLUTCH/BRAKE SHIFTING YOKE
625	HIGH SPEED CLUTCH COMPLETE	659	SHOULDER SCREW	OC1-4	HIGH SPEED CLUTCH YOKE
625A	HIGH SPEED CLUTCH SLEEVE	660	NUT	OC1-5	LARGE BEARING HOUSING CASTING
625B	THRUST BEARING—E-20	661	T-SLOT NUT	OC1-6	SMALL BEARING HOUSING CASTING
625C	HIGH SPEED CLUTCH DISC W/FACING	662	SCREW		
626	HIGH SPEED SPROCKET	663	HARD WASHER		
627	SNAP RING	664	BUSHING		
628	BEARING—SL-16	665	OVERRUNNING CLUTCH HUB CASTING		

## REED SWITCH

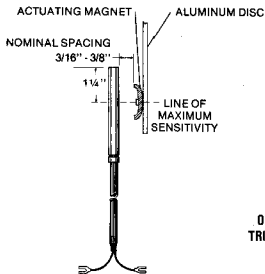

## MODEL 102 COUNTER

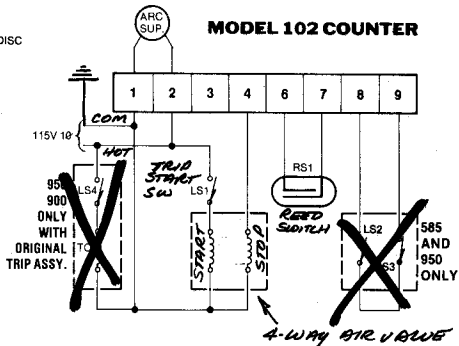

## MODEL 204 COUNTER

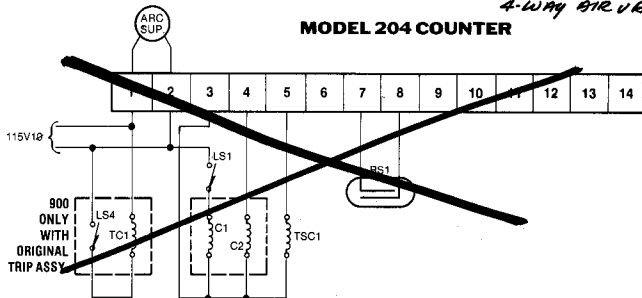

## PNEUMATIC CIRCUIT

