

PARTS & OPERATION MANUAL

FOR

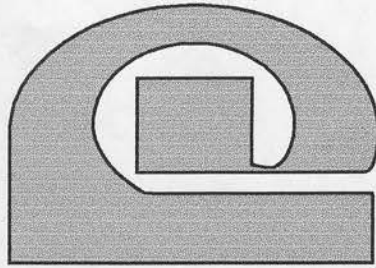

**CRITTENDEN
CONVERSION
CORPORATION**

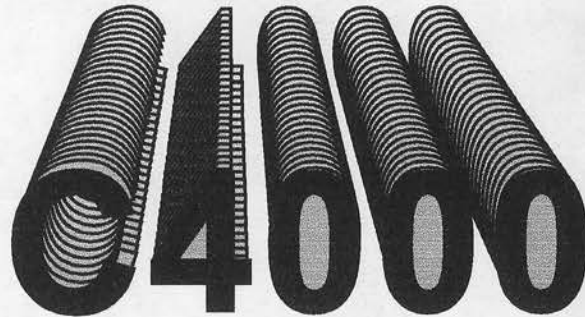

C4000 LAMINATOR

INTRODUCTION

Crittenden Conversion. Crittenden Conversion, founded 1971, began by making improved parts for existing box-making machinery. We sought the highest grade of materials to make lasting parts; a higher quality of parts than the original manufacturer's. These were not merely spare parts. We converted machines, one part at a time, into better, longer-lasting equipment. Therefore, our name ***Crittenden Conversion.***

Throughout the world Crittenden Conversions machines are meeting today's demands for faster, more reliable and economical production. The C4000 Bulk Bin Laminator is an example of this effort. This machine is designed, engineered and constructed to provide trouble free operation. The machine is designed to operate automatically with multiple systems operating simultaneously. ***Extreme caution must be exercised at all times when operating this equipment!***

- Permit only trained and authorized employees to operate equipment.
- Inspect and maintain guards, safety devices, and start & stop controls.

DO NOT ATTEMPT ANY UNAUTHORIZED SYSTEM ADJUSTMENTS!

Please call us if you have any questions 1-800-755-7894

TABLE OF CONTENTS

LIFT	Chain Lift	40I001
GLUER	Gluer/ Feeder	41I004
MAKEUP	Belt/Pulley Assembly	42I002
	Liner Placement Assembly	42I003
2-COMP	Double Compression	43I001
	Weight Wheel	44I004
SCORE	Spanker Bar Assembly	44I002
	Straightening Bar Assembly	44I003
	Score Drive Assembly	44I006
	Score Register Assembly	44I007
	Score Assembly	44I008
FOLDER	Liner Glue Applicator	45I001
	Vaccum Carriage	45I002
	Folder, End Off-Feed	45I003
	Folder, Side Off-Feed	45I003s
	Side Off-Feed Pull Roll	45I004
	Side Off-Feed Pinch Rolls	45I005
	Side Off-Feed Lifting Arm	45I006
	Folder Rack Assembly	45I007
	Vacuum System Assembly	45I008
4-COMP	Four Station Compression	46I001
CONVEYOR	Conveyor Assembly	47I001
SYSTEMS	Electrical & Pneumatics (Typ)	48I001
	Hyd In-Feed System	48L002
	Hyd Score System	48L004
	Hyd Out-Feed System	48L003

PARTS ORDERING INFORMATION

To order parts please send, phone or fax the following information to:

Crittenden Conversion Corp.
P.O. Box 719 30380 S.E. High Point Way
Preston, WA 98050
Ph:(800) 755-7894
Fax:(206)222-6449

Refer to the Machine Layout (First Drawing) and identify the section on the machine that you are ordering parts for. Go to that section and find the parts you need. When ordering please include the following information: ▼

TABLE ▼ 4XXXXX-A

REF NO ▼	PART NO ▼	QTY ▼	PART NAME ▼
----------	-----------	-------	-------------

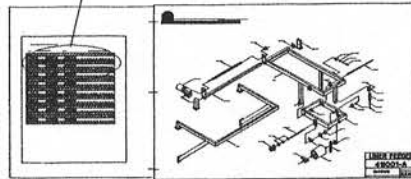

PURCHASE ▼ ORDER NO. HOW & WHERE TO SHIP NAME OF PERSON ORDERING ▼

REF NO	PART NO	QTY	PART NAME	DWG
01	40P011-A	20	BRASS WASHER	40I001
02	40P007-A	2	CHAIN ADJUSTING BOLT, LARGE CHAIN	40I001
03	40P066-A	4	1" - 14 NON-PLATED NUT	40I001
04	40P004-A	3	CHAIN ROLLER-4"	40I001
09	40P024-A	2	SERVICE CATCH ROLLER	40I001
11	40P075-A	6	CIRCLIP	40I001
12	40P088-A	1	CHAIN/LARGE/SHORT	40I001
14	40P039-A	4	GUIDE ROLLER PLATE	40I001
15	40P009-A	4	GUIDE ROLLER	40I001
17	40P029-A	4	SAFETY CATCH ROD	40I001
19	40P089-A	2	CHAIN,SMALL	40I001
20	40P096-A	4	CHAIN ROLLER, 2-3/4"	40I001
21	40P003-A	2	CHAIN ADJUSTING BOLT, SMALL CHAIN	40I001
24	40P090-A	1	CHAIN,LARGE,LONG	40I001
26	40P013-A	1	MOVEABLE CLEVIS	40I001
27	40PXXX-A	1	HYDRAULIC CYLINDER, SPECIFY LIFT	40I001
28	40P109-A	1	CLEVIS PIN, SPECIFY LIFT	40I001
29	40P046-A	1	ROLLER, 4-3/4"	40I001
30	40P010-A	4	LEG WELDMENT, SPECIFY HIGHT	40I001
31	40P063-A	1	ROLLER, 3-1/4"	40I001
32	40P049-A	2	CROSS BEAM PIVOT PIN	40I001
33	40P107-A	2	CHAIN ANCHOR BOLT	40I001
34	40P008-A	2	CHAIN ANCHOR WELDMENT	40I001
35	40P016-A	1	SERVICE CATCH PIN	40I001
36	40P001-A	2	CHAIN ANCHOR	40I001
37	40P017-A	4	LOUISIANA PLATE	40I001
38	40P018-A	4	TEXAS PLATE	40I001
39	40P095-A	4	CHAIN ATTACHMENT BOLT	40I001
40	40P108-A	4	GUIDE ROLLER BOLT	40I001
41	40P006-A	4	SAFETY CATCH PLATE	40I001
42	40P106-A	4	SPRING	40I001
43	40P094-A	4	SAFETY CATCH WASHER	40I001
44	40P055-3	5	BOLT/NUT ASSEMBLY, LARGE CHAIN	40I001
45	40P055-2	2	BOLT/NUT ASSEMBLY, SMALL CHAIN, CYL. SIDE	40I001
46	40P055-4	2	BOLT/NUT ASSEMBLY, SMALL CHAIN, OTHER SIDE	40I001
47	40P056-3	5	BEARING SPACER,, LARGE CHAIN	40I001
48	40P056-2	2	BEARING SPACER, SMALL CHAIN, CYL. SIDE	40I001
49	40P056-4	2	BEARING SPACER, SMALL CHAIN, OTHER SIDE	40I001

Note: To Order Roller Bolt Assembly, Specify Roller P/N & Location →

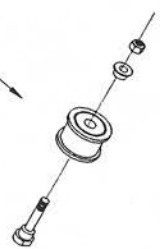
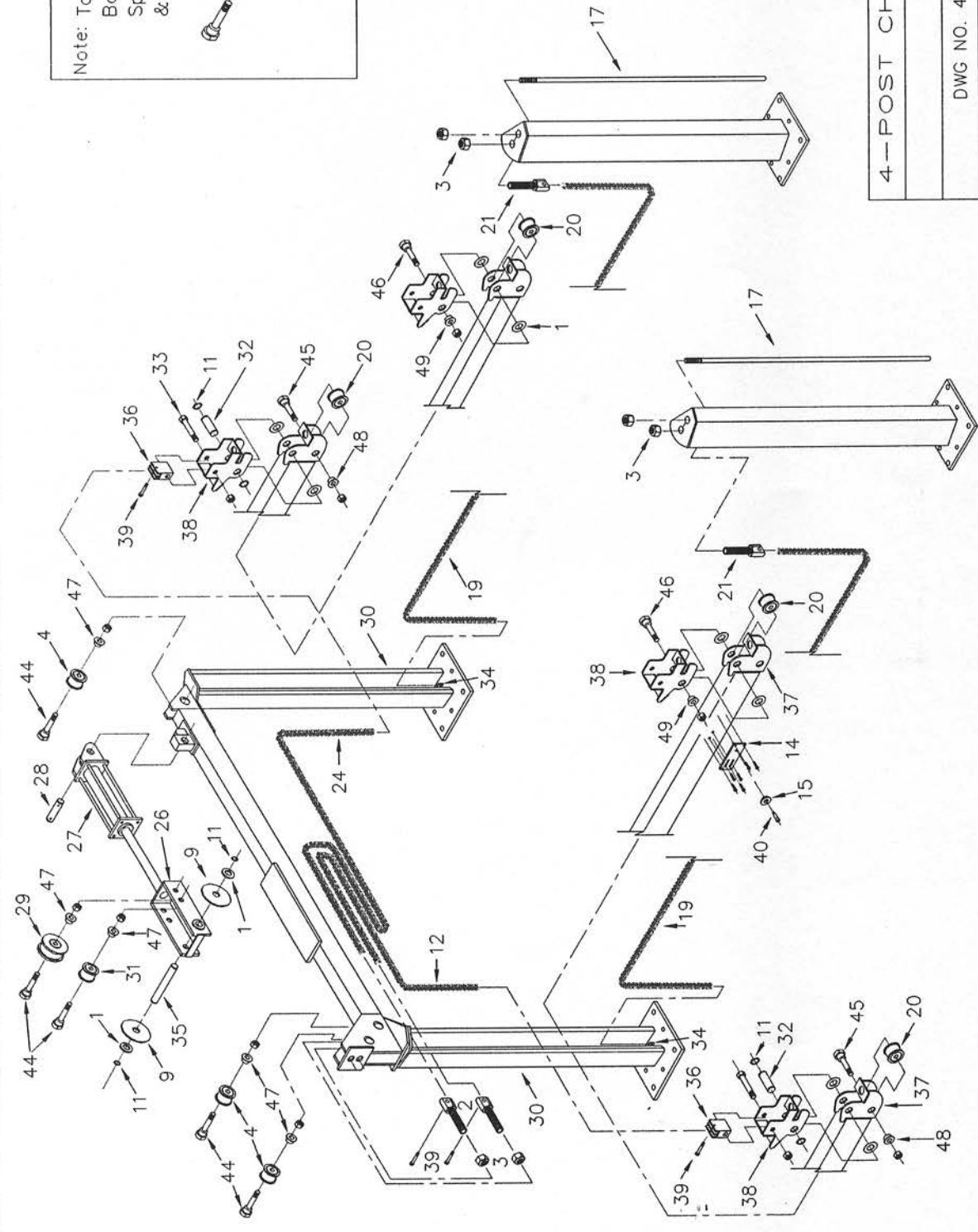
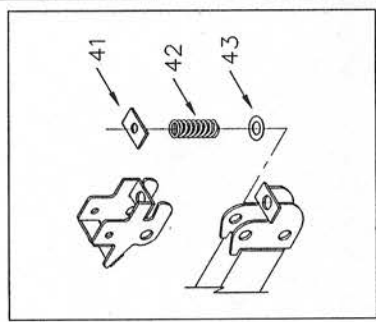
Vacuum Feeder

Dwg# 41i005-A

Ref. #	Part #	Part Description
1	41P071-A	REATAINING WHSHER
2	41P072-A	7/8" BORE MOTOR/GEAR BOX
3	41P024-A	2 X 2 PIVOT SHAFT
4	41P070-A	1" 4 HOLE FLANGE BEARING
5	41P073-A	LEAD SCREW
6	41P020-A	SUPPORT FRAME
7	41P074-A	LEAD SCREW NUT
8	41P018-A	SLIDING FRAME
9	41P065-A	1" 3 HOLE FLANGE BEARING
10	41P069-A	VEE WHEEL
11	41P068-A	ROLLER BEARING
12	41P067-A	THRUST WASHER
13	41P066-A	SHOULDER BOLT
14	41P021-A	PIVOT SHAFT
15	44P122-A	CLEVIS PIN
16	44P121-A	CLEVIS
17	44P087-A	2 X 2 AIR CYLINDER
18	41P030-A	RH 1/2-20 JAM NUT
19	41P152-A	CYLINDER EXTENSION ROD
20	41P155-A	LH 1/2-20 JAM NUT
21	41P156-A	LH 1/2-20 MALE ROD END
22	41P153-A	VACUUM FEEDER FRAME
23	41P151-A	RODLESS CYLINDER BODY MOUNT
24	41P137-A	RODLESS LINER FEED CYLINDER
25	41P139-A	VACUUM GENERATOR
26	41P135-A	VACUUM MANIFOLD
27	41P138-A	VACUUM CUP
28	41P149-A	BEARING PLATE, GEAR SIDE
29	41P141-A	6 1/2" GEAR
30	41P147-A	DRIVEN SHAFT
31	41P148-A	DRIVE SHAFT
32	41P133-A	NO-CRUSH ROLL HUB
33	41P144-A	NO-CRUSH ROLL
34	41P150-A	BEARING PLATE, CHAIN SIDE
35	47P036-A	HYDRAULIC MOTOR
36	41P060-A	SPRAGUE CLUTCH
37	41P026-A	SPRAGUE CLUTCH SPROCKET
38	41P151-A	HYDRAULIC MOTOR MOUNT
39	41P154-A	HYDRAULIC MOTOR SPROCKET
40	41P058-A	CHAIN #40
41	41P157-A	PHOTOEYE MOUNT
42	41P142-A	LOAD LEVEL PHOTOEYE MOUNT

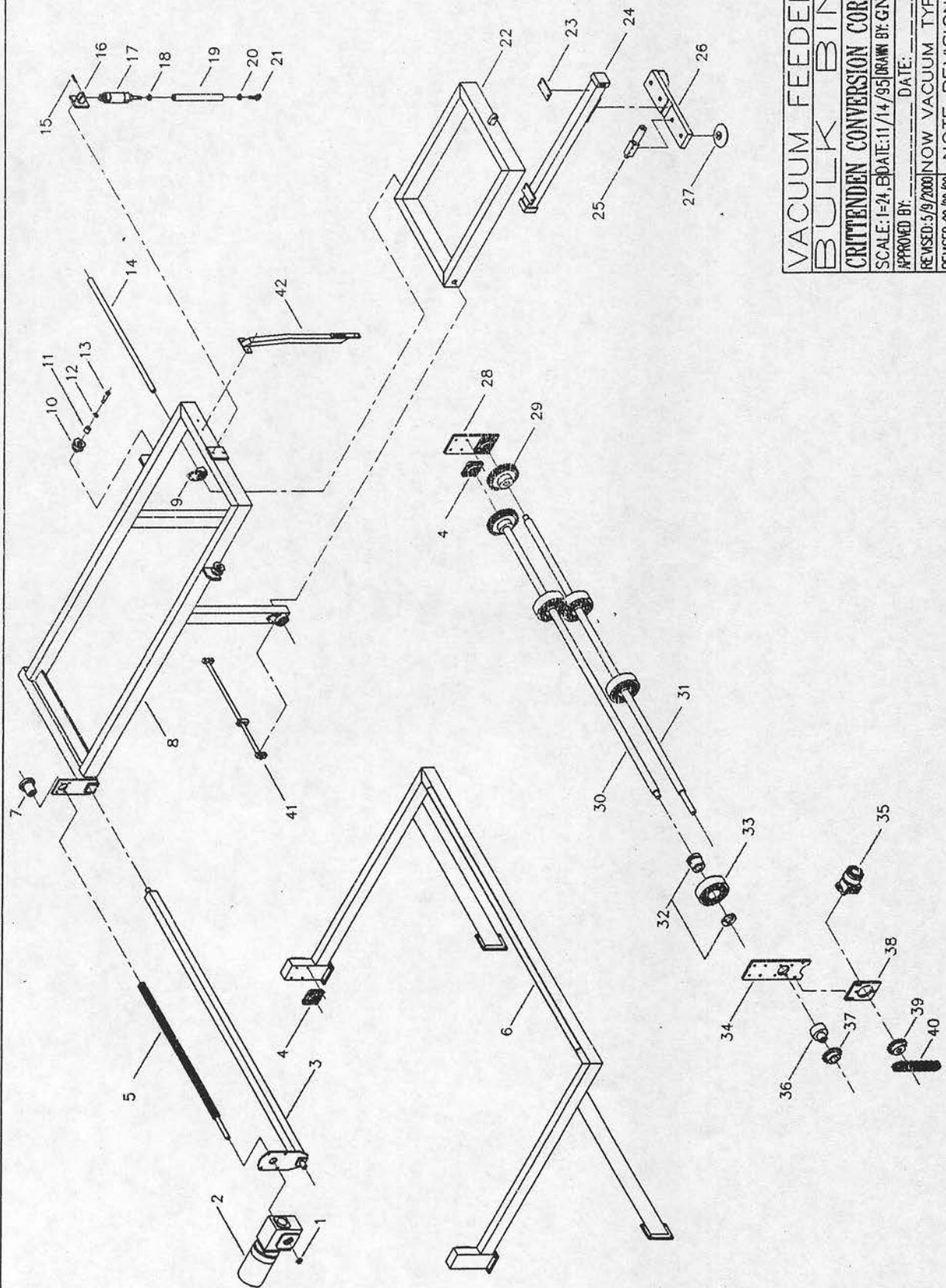

VACUUM FEEDER
BULK BIN
CRITTENDEN CONVERSION CORP.
 SCALE: 1/2" = 1" DATE: 11/14/95 DRAWN BY: GNB
 APPROVED BY: _____ DATE: _____
 REVISED: 5/9/2000 INOW VACUUM TYPE _____
 REVISED: 00/00/00 NOTE REVISION _____

MFG # 0000
 DWG # 41005-A

Roll Coater**Dwg# 41i004-A**

Ref. #	Part #	Part Description
1	43P040-A	HYDRIC MOTOR
2	41P076-A	BEARING BLOCK
3	41P145-A	SPROCKET, #40 DOUBLE
4	41P004-A	OUTFEED LINER DEFLECTOR
5	41P014-A	GLUE DAM, RIGHT
6	41P013-A	GLUE DAM, LEFT
7	41P032-A	LINER INFEED SHIELD

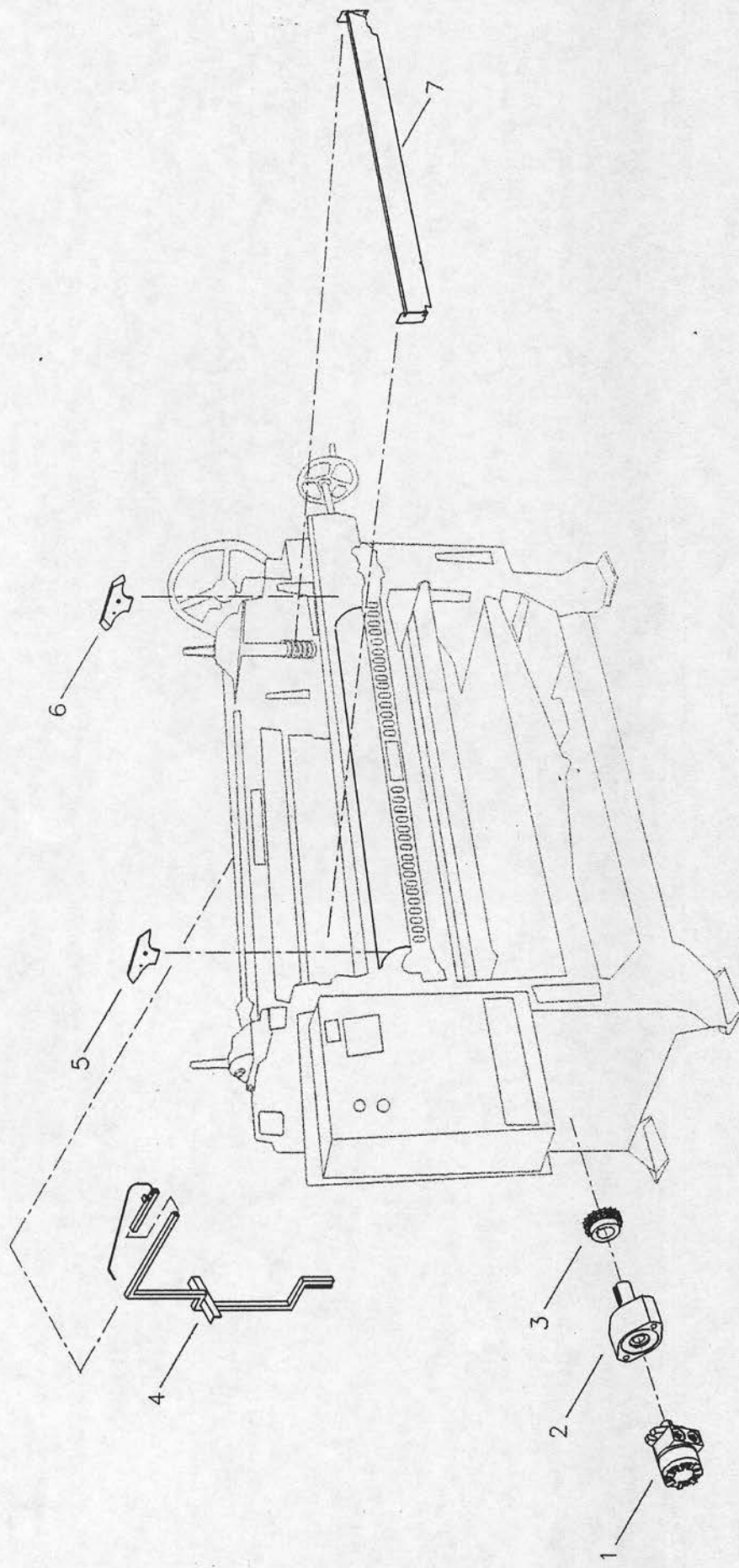

 CRITTENDEN CONVERSION CORPORATION	
GLUER BULK BIN	
CRITTENDEN CONVERSION CORP.	
DATE: 11/1/2000	DWG# 4-1100 4

TABLE 42I002-BACK STOP/BELT PULLEY ASSY

5/8/98

REF NO	PART NO	QTY	PART NAME	DWG
1	41P065-A	2	1" 3 HOLE FLANGE BEARING	42I002
2	45P102-A	1	6" SPLIT CROWN PULLEY	42I002
3	46P102-A	4	4" SPLIT CROWN PULLEY	42I002
4	41P062-A	1	LOVEJOY COUPLING. 100	42I002
5	43P040-A	1	HYDRAULIC MOTOR	42I002
6	42P102-A	1	DRIVE SHAFT	42I002
7	42P104-A	1	ADJUSTER SHAFT	42I002
8	42P103-A	3	IDLER SHAFT	42I002

BACK STOP-BELT/PULLEY ASSY

DWG NO. 421002

SCALE: NTS/DATE:01/97

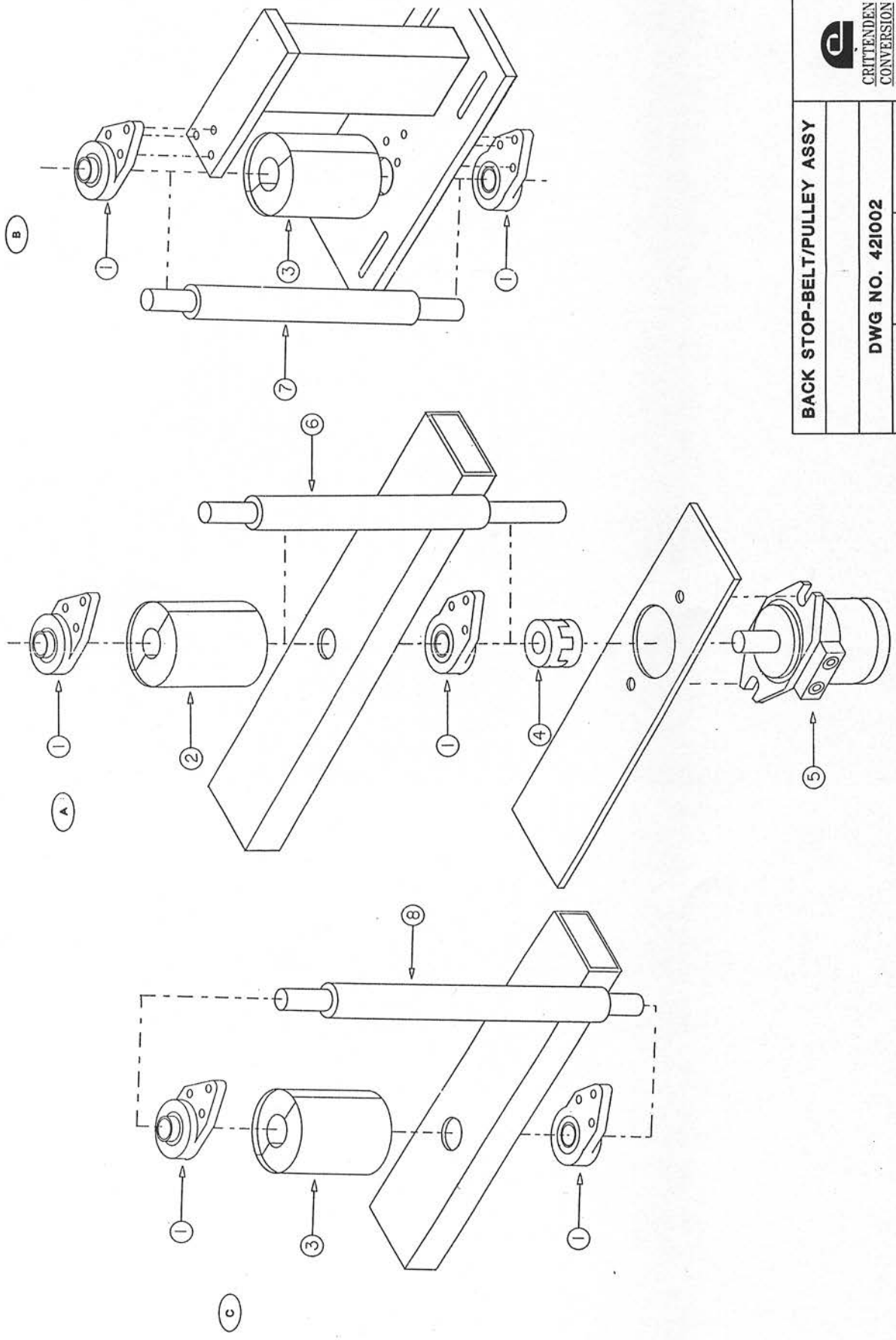

TABLE 42I003-BACK STOP/LINER PLACEMENT

5/8/98

REF NO	PART NO	QTY	PART NAME
1	42P116-A	3	AIR CYLINDER
2	42P005-A	2	GUIDE BLOCK
5	42P007-A	2	LOCATING BLADE
6	42P008-A	1	CENTER LOCATING PIN
7	42P117-A	2	AIR CYLINDER, 2 X 6
8	42P101-A	2	CYLINDER MOUNT CAP
9	42P139-A	2	LINER LOCATING ADJUSTABLE ARM
10	42P141-A	2	INNER VERTICAL LINER PLACEMENT TUBE
11	42P012-A	1	LINER PLACEMENT BAR
12	42P013-A	1	LINER PLACEMENT BRACKET
13	45P137-A	6	SNUBBER
14	42P129-A	4	SHORT GUIDE
14	42P130-A	4	TALL GUIDE
15	42P132-A	4	SHORT WEAR PAD
15	42P133-A	4	TALL WEAR PAD



BACK STOP-LINER PLACEMENT ASSY

DWG NO. 421003

SCALE: NTS DATE: 01/97

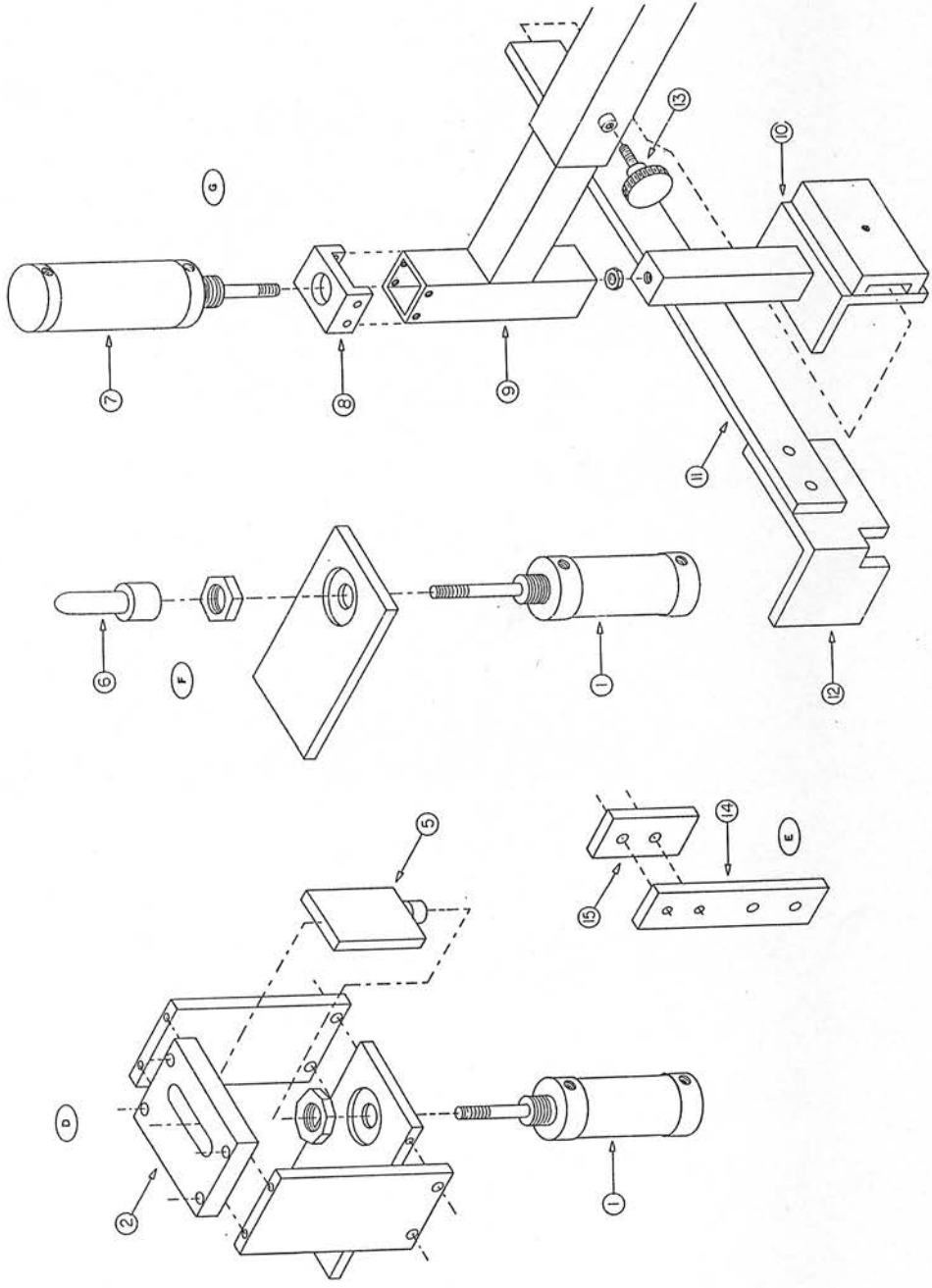

TABLE 43I001-DOUBLE COMPRESSION

5/8/98

REF NO	PART NO	QTY	PART NAME	DWG
1	43P113-A	8	1 3/4" 4 HOLE FLANGE BEARING	43I001
2	43P114-A	4	1 3/4" TAP BASE BEARING	43I001
3	45P102-A	40	6" SPLIT CROWN PULLEY	43I001
4	42P025-A	2	DRIVEN PULLEY SHAFT	43I001
4A	43P002-A	2	IDLER PULLEY SHAFT	43I001
5	43P128-A	2	QUICK FLEX COUPLING	43I001
6	47P036-A	2	HYDRAULIC MOTOR	43I001
7	46P021-A	8	COMPRESSION PAD	43I001
8	43P117-A	32	CYLINDER PIN	43I001
9	48P075-A	16	AIR CYLINDER-3.25 X 4	43I001
10	43P117-A	16	CLEVIS	43I001
11	43P119-A	8	GUIDE ROLLER	43I001
12	43P004-A	8	GUIDE ROLLER WASHER	43I001
13	43P005-A	2	BOX GUIDE	43I001
14	43P006-A	2	LEAD IN DEFLECTOR	43I001
15	43P015-A	2	ADJUSTABLE DEFLECTOR	43I001
16	43P016-A	1	DEFLECTOR MOUNT BAR	43I001
18	43P014-A	1	SPRING	43I001



DOUBLE COMPRESSION

DWG NO. 431001

SCALE: NTS DATE: 01/97

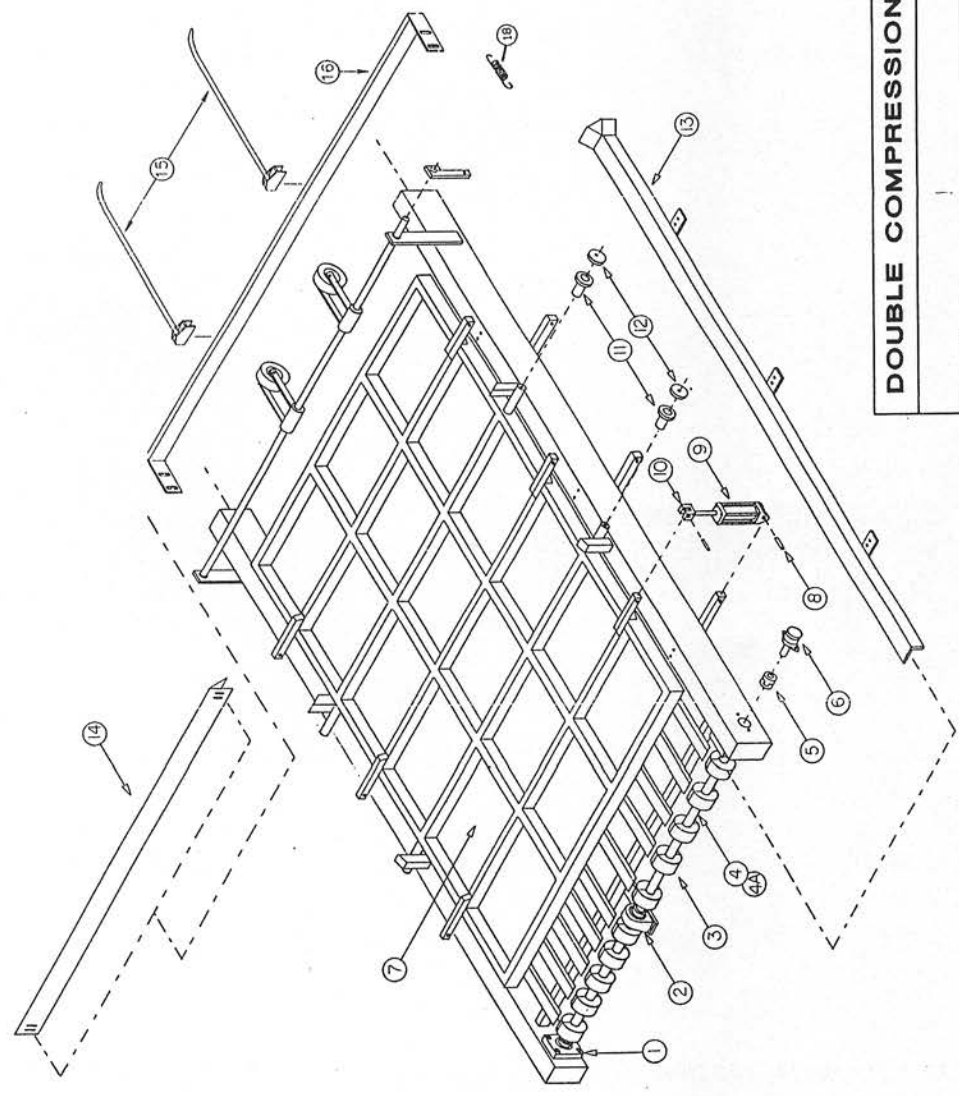
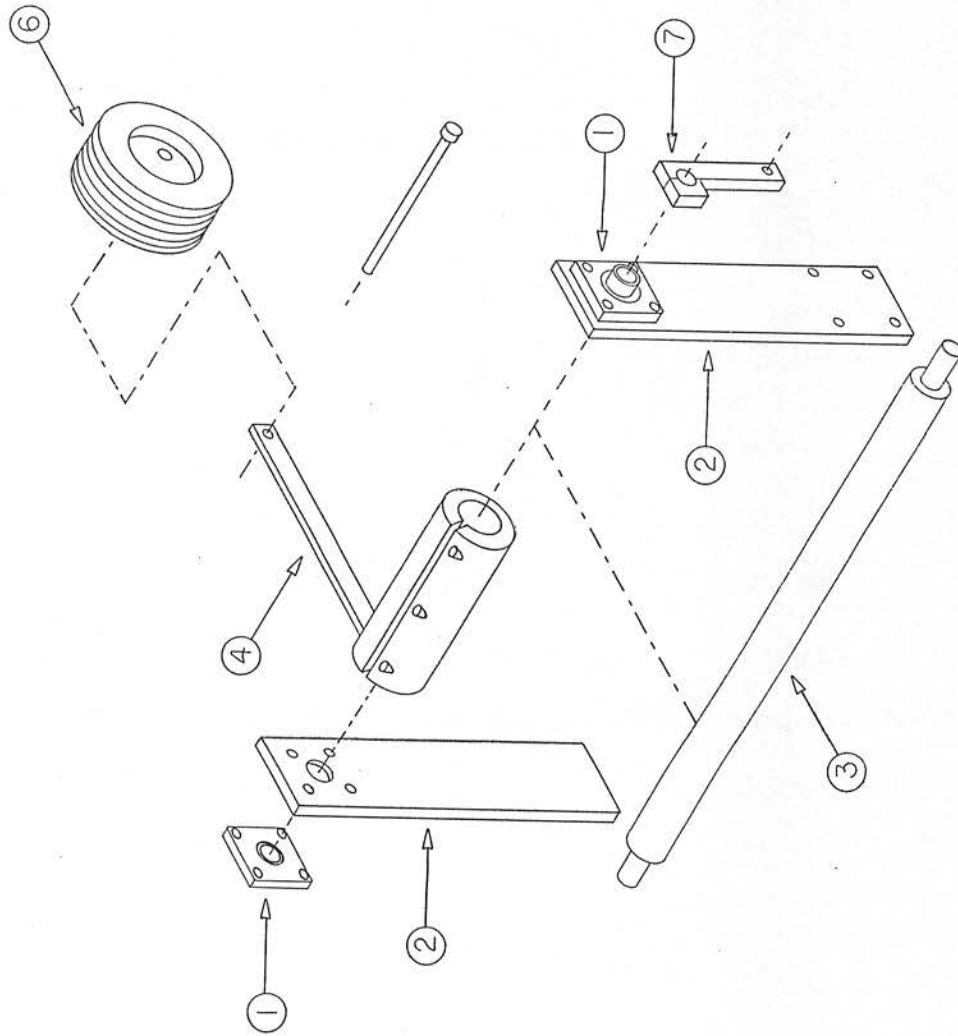

TABLE SCORE/WIEGHT WHEEL-44I004

5/8/98

REF NO	PART NO	QTY	PART NAME	DWG
1	41P070-A	2	1" 4 HOLE FLANGE BEARING	44I004
2	44P039-A	2	MOUNTING PLATE	44I004
3	43P008-A	1	WEIGHT WHEEL PIVOT SHAFT	44I004
4	43P007-A	2	WEIGHT WHEEL CLEVIS	44I004
6	44P041-A	2	WEIGHT WHEEL	44I004
7	44P065-A	1	WIEGHT WHEEL LIFTING ARM	44I004



DOUBLE COMPRESSION

441004-A

C-4000 DATE: 03/06/96

BULK BIN LAMINATOR 4400D

REF NO	PART NO	QTY	PART NAME	DWG
1	44P122-A	1	PIN	44I002
2	44P121-A	1	CLEVIS	44I002
3	44P087-A	1	2 X 2 AIR CYLINDER	44I002
4	44P115-A	1	ROD END	44I002
5	44P006-A	1	SPANKER BAR	44I002
6	44P007-A	1	5/8" X 7/8" X 1" OILITE BUSH	44I002
7	44P008-A	1	UHMW WASHER	44I002
8	44P009-A	6	BRACKET	44I002
9	44P026-A	6	WEAR PLATE	44I002
10	44P027-A	12	WASHER	44I002
11	44P028-A	12	SHAFT	44I002
12	44P116-A	12	1" SQUEEZE COLLAR	44I002
13	44P029-A	12	1" X 1 1/4" X 2" OILITE BUSHING	44I002
14	44P030-A	10	2 3/16" DIA. ROLLER	44I002
14	44P179-A	2	1 15/16" DIA. ROLLER	44I002
16	44P032-A	2	STAIGHTENING BAR	44I002
17	44P033-A	4	HORIZONTAL WEAR PAD	44I002
18	44P034-A	4	VERTICAL WEAR PAD	44I002

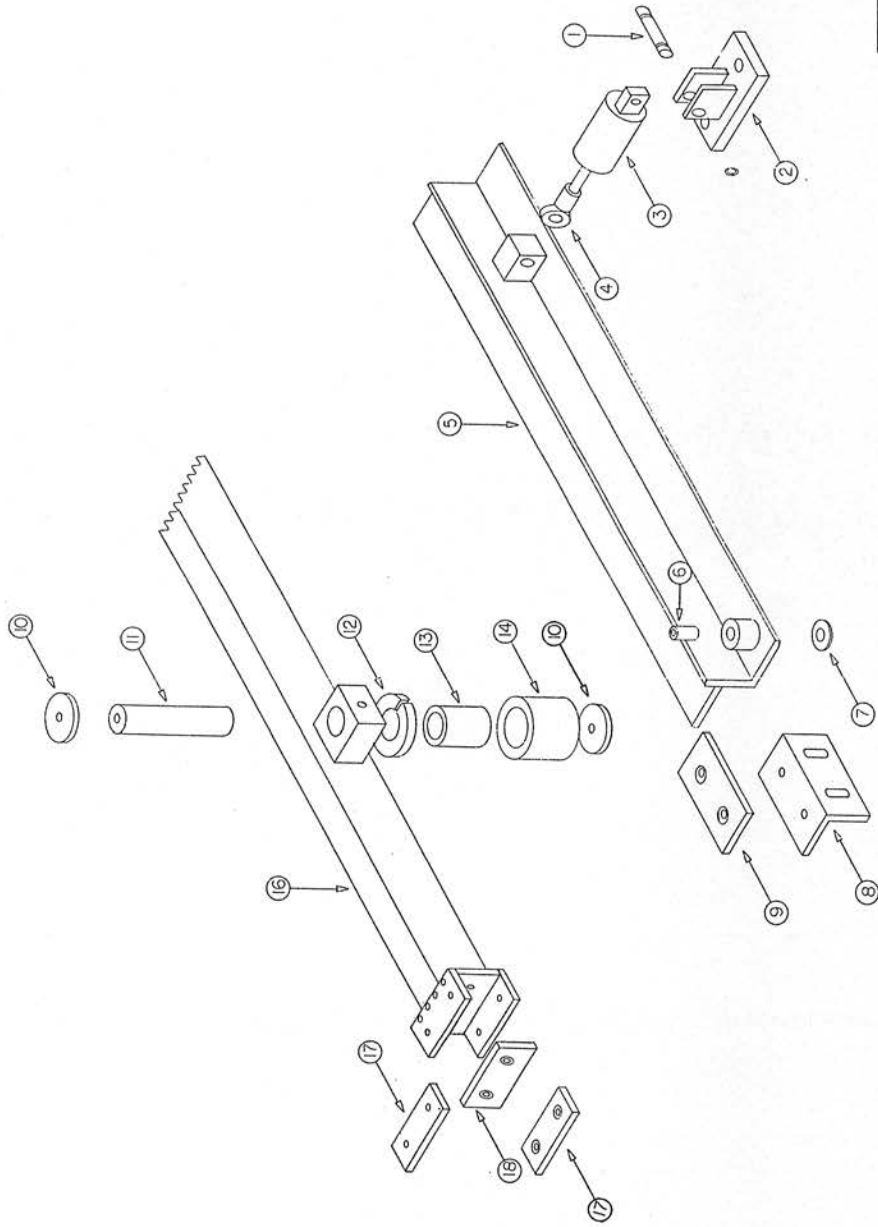

SCORE SECTION
441002-A
 C4000 DATE: 03/06/96
 BULK BIN LAMINATOR 4400B

TABLE SCORE/STRAIGHTENING-44I003

5/8/98

REF NO	PART NO	QTY	PART NAME	DWG
01	41P027-A	4	1/2" BUSHED SPROCKET	44I003
02	44P035-A	8	ADJUSTING SCREW	44I003
03	44P036-A	2	ADJUSTING HANDLE	44I003
04	44P117-A	4	1" BORE SPROCKET	44I003
05	41P065-A	6	1" 3 HOLE FLANGE BEARING	44I003
06	44P037-A	2	CLAMP BLOCK	44I003
08	44P038-A	2	SHAFT	44I003

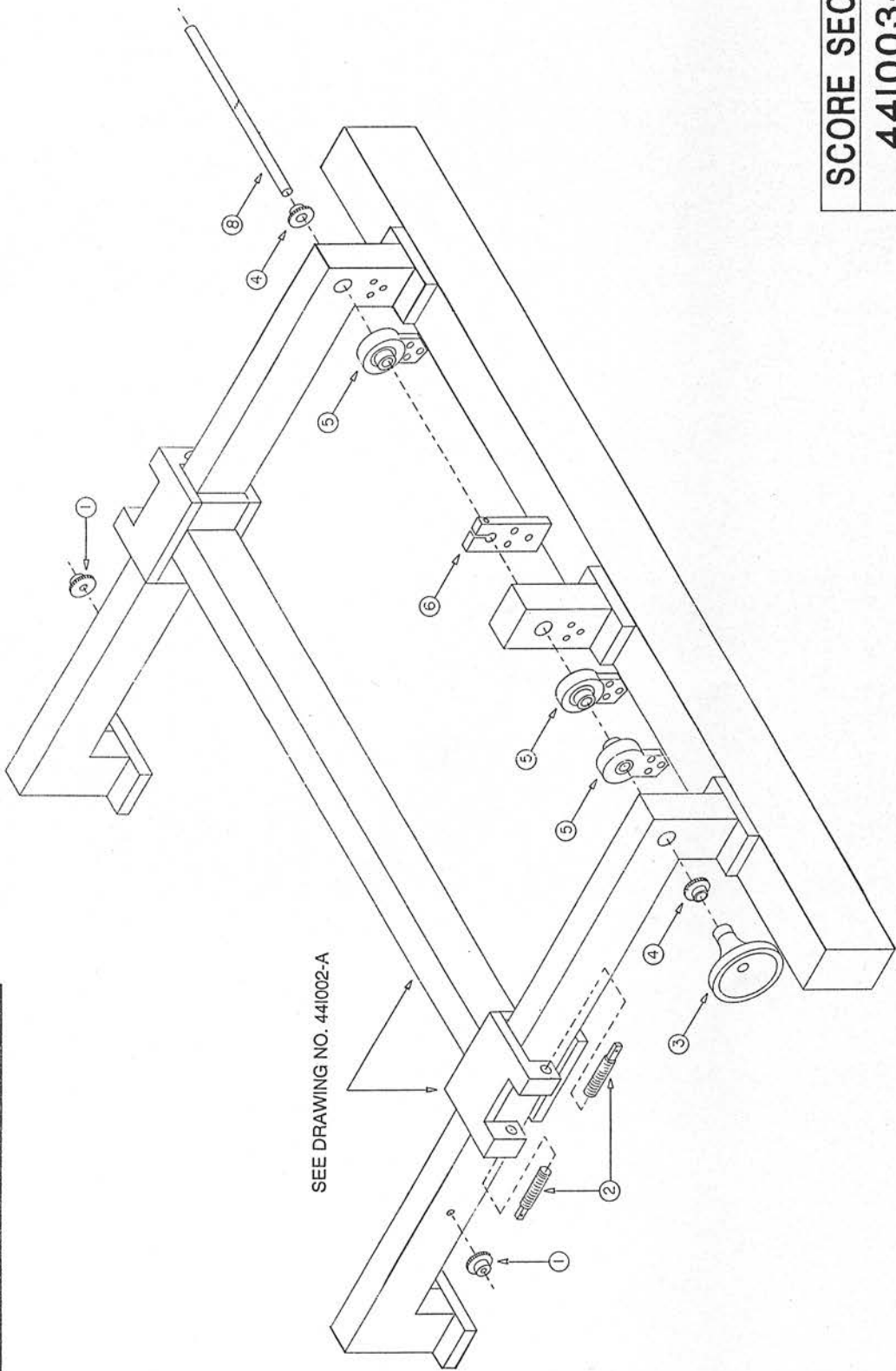

SEE DRAWING NO. 441002-A

SCORE SECTION	
441003-A	
C4000	DATE: 03/06/96
BULK BIN LAMINATOR 4400C	

TABLE 44I006-SCORE DRIVE ASSY

5/8/98

REF NO	PART NO	QTY	PART NAME
09	43P113-A	10	FLANGE BEARING-1 3/4" 4 HOLE
10	43P114-A	4	TAP BASE BEARING-1 3/4"
12	45P035-A	10	REGISTER ROLL
13	45P102-A	18	SPLIT CROWN PULLEY-6"
15	44P128-A		SHEAVE & TAPER LOCK BUSHING
17	44P107-A	1	HTD TAKE UP
32	44P131-A	2	1 3/4" BORE GEAR
33	44P069-A	1	MAIN DRIVE SHAFT (FOLDER SIDE)
34	44P070-A	1	MAIN DRIVE SHAFT (COMPRESSION SIDE)
35	44P068-A	1	CONVEYOR DRIVE SHAFT
36	43P002-A	1	PULLEY IDLER SHAFT
38	44P133-A	1	SERO DRIVE SHEAVE & TAPER LOCK BUSHING
40	44P135-A	1	SERVO DRIVE MOTOR
41	44P056-A	2	SERVO MOTOR IDLERS
42	44P057-A	2	SERVO ECCENTRIC TIGHENER
43	44P180-A	1	MAIN DRIVE BELT
44	44P181-A	1	INFEED DRIVE BELT

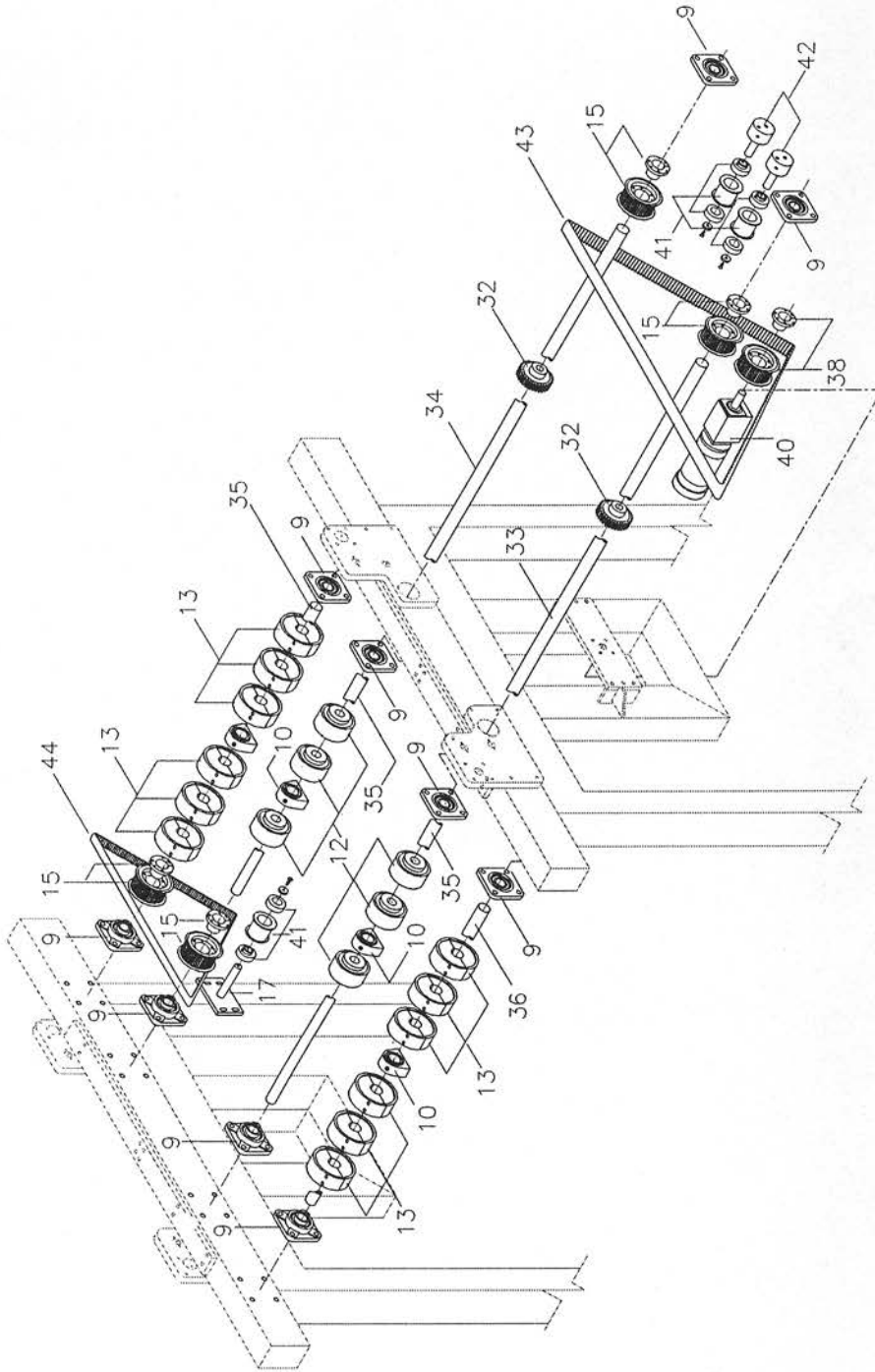

SCORE DRIVE ASSY

C4000 BULK BIN LAMINATOR

DWG NO. 441006

EDIT: 4/20/98|DATE: 04/17/97|PLOT 1 = 19



CRITTENDEN
CONVERSION
CORPORATION

TABLE 44I007-SCORE REGISTER ASSY

5/11/98

REF NO	PART NO	QTY	PART NAME	DWG
01	44P055-A	4	STAR KNOB	44I007
02	44P065-A	2	ADJUSTING ARM (STAR KNOB)	44I007
03	41P070-A	4	FLANGE BEARING-1" 4 HOLE	44I007
04	44P059-A	2	2" SHAFT	44I007
06	44P042-A	4	WEIGHT WHEEL LIFTING ARM	44I007
07	44P064-A	4	UPPER REGISTER SHAFT LIFTING ARM	44I007
11	41P065-A	4	FLANGE BEARING-1" 3 HOLE	44I007
18	44P072-A	4	TURNBUCKLE ASSEMBLY	44I007
19	44P067-A	2	UPPER REGISTER LIFTING SHAFT	44I007
20	44P073-A	4	WASHER	44I007
21	44P143-A	2	1 1/8" BORE DRIVE GEAR	44I007
23	44P066-A	2	UPPER REGISTER SHAFT	44I007
26	44P063-A	8	WEAR SPACER	44I007
28	44P058-A	2	4 1/8" SHAFT	44I007
29	44P182-A	4	1" BORE IDLER GEAR	44I007
31	44P060-A	2	3 1/16" SHAFT	44I007

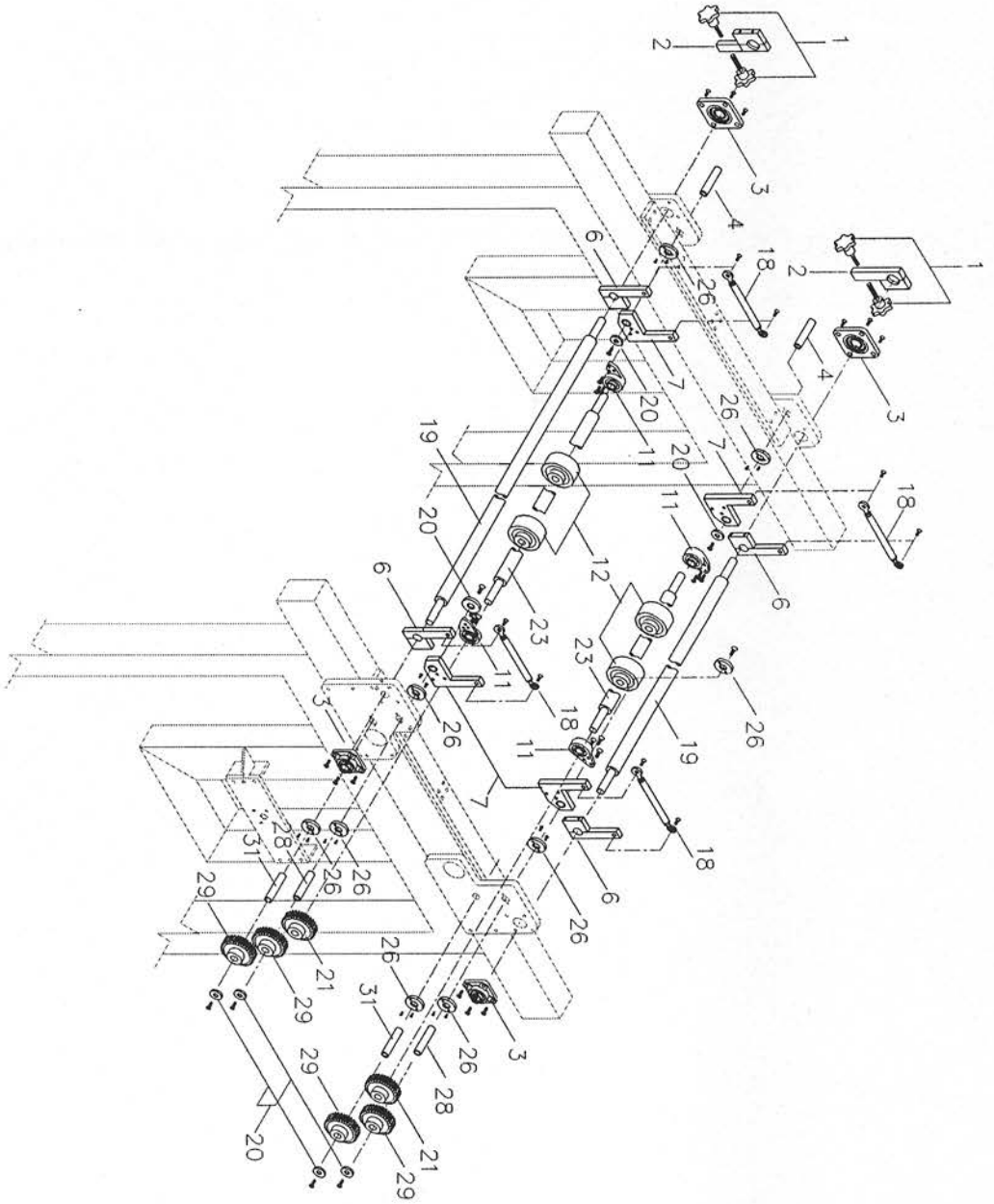

SCORE REGISTER ASSY
 C4000 BULK BIN LAMINATOR
 DWG NO. 441007
 EDIT: 4/21/98 DATE: 04/17/97 PLOT 1 = 19



TABLE 44I008-SCORE ASSY

5/11/98

REF NO	PART NO	QTY	PART NAME	DWG
01	44P001-A	2	HOUSING CAP	44I008
02	44P077-A	4	HOUSING BASE	44I008
03	44P003-A	8	WEAR PLATE	44I008
04	44P004-A	2	UPPER SCORE BAR	44I008
05	44P005-A	4	GUIDE BLOCK	44I008
06	44P013-A	1	90 DEG. UPPER SCORE PROFILE	44I008
07	44P012-A	1	90 DEG. LOWER SCORE PROFILE	44I008
08	44P016-A	1	180 DEG. UPPER SCORE PROFILE	44I008
09	44P014-A	1	180 DEG. LOWER SCORE PROFILE	44I008
10	44P124-A	4	SCORE CYL	44I008
11	44P125-A	8	CLEVIS PIN	44I008
12	44P126-A	4	CLEVIS	44I008
13	44P076-A	8	UPRIGHT GUIDE	44I008

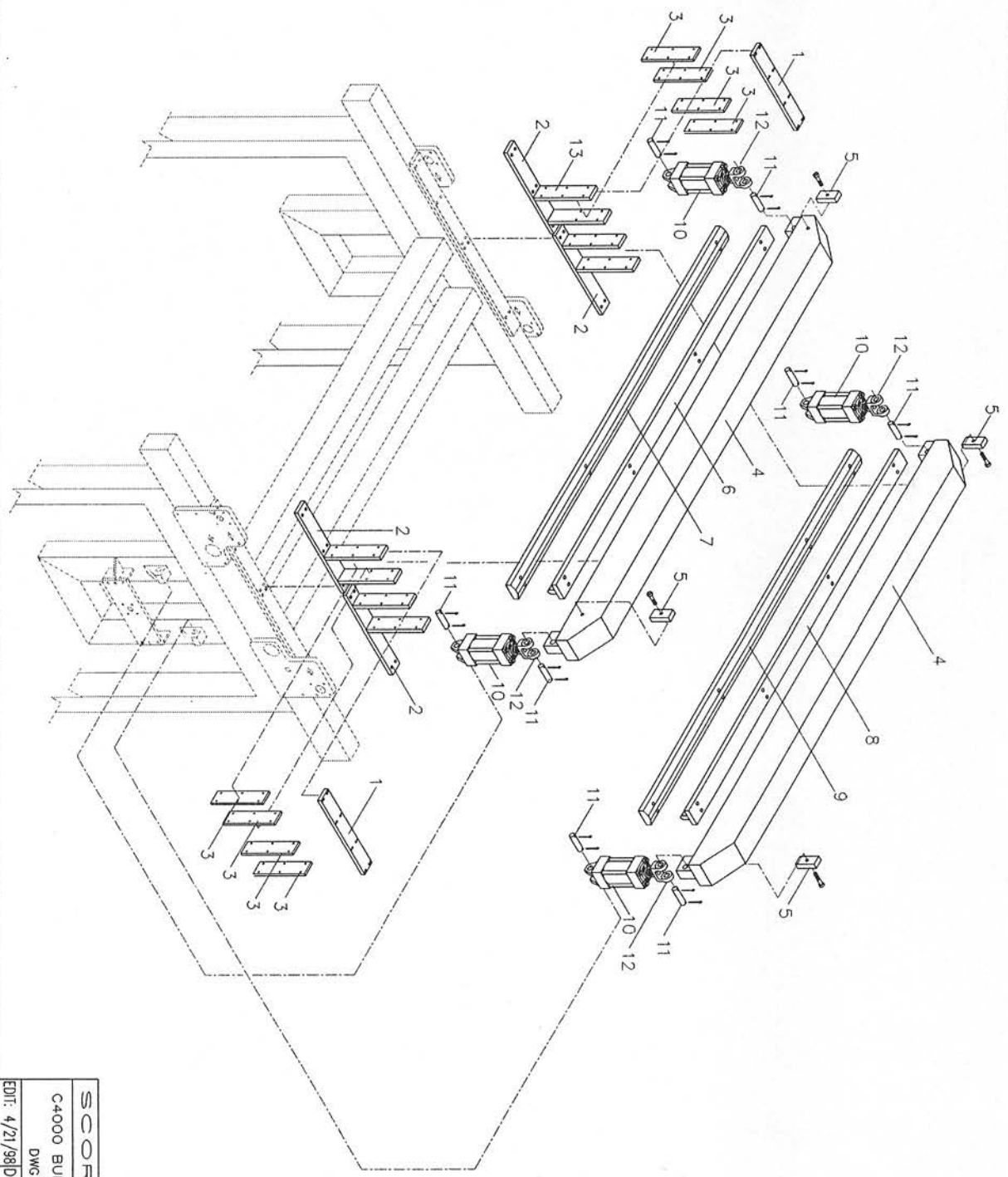

SCORE ASSY
 C4000 BULK BIN LAMINATOR
 DWG NO. 441008
 EDIT: 4/21/98|DATE:04/17/97|PLOT 1 = 22



REF NO	PART NO	QTY	PART NAME	DWG
1	45P006-A	1	CARRIAGE	45I001
2	45P007-A	2	SHAFT, SPECIFY LENGTH	45I001
3	45P008-A	2	ADJUSTMENT ARM	45I001
4	45P009-A	2	SQUARE MOUNT SHAFT	45I001
5	45P168-A	2	GLUE HEAD, 3" 11 HOLES	45I001
5	45P003-A	2	GLUE HEAD, 3 1/2" 13 HOLES	45I001
5	45P162-A	1	GLUE HEAD, 7 1/2 X 3" STEPPED 16 HOLE	45I001
5	45P163-A	1	GLUE HEAD, 7 1/2 X 3" 17 HOLES	45I001
5	45P098-A	2	GLUE HEAD, 4" 15 HOLES	45I001
7	45P131-A	1	RODLESS CYLINDER	45I001
8	48P076-B	2	SPRING ARM	45I001
9	48P076-A	2	GLUE VALVE	45I001
10	45P170-A	2	MALE SWIVEL	45I001
10	45P169-A	2	FEMALE SWIVEL	45I001
N.S.	45P104-A		VALCO REPAIR KIT	45I001

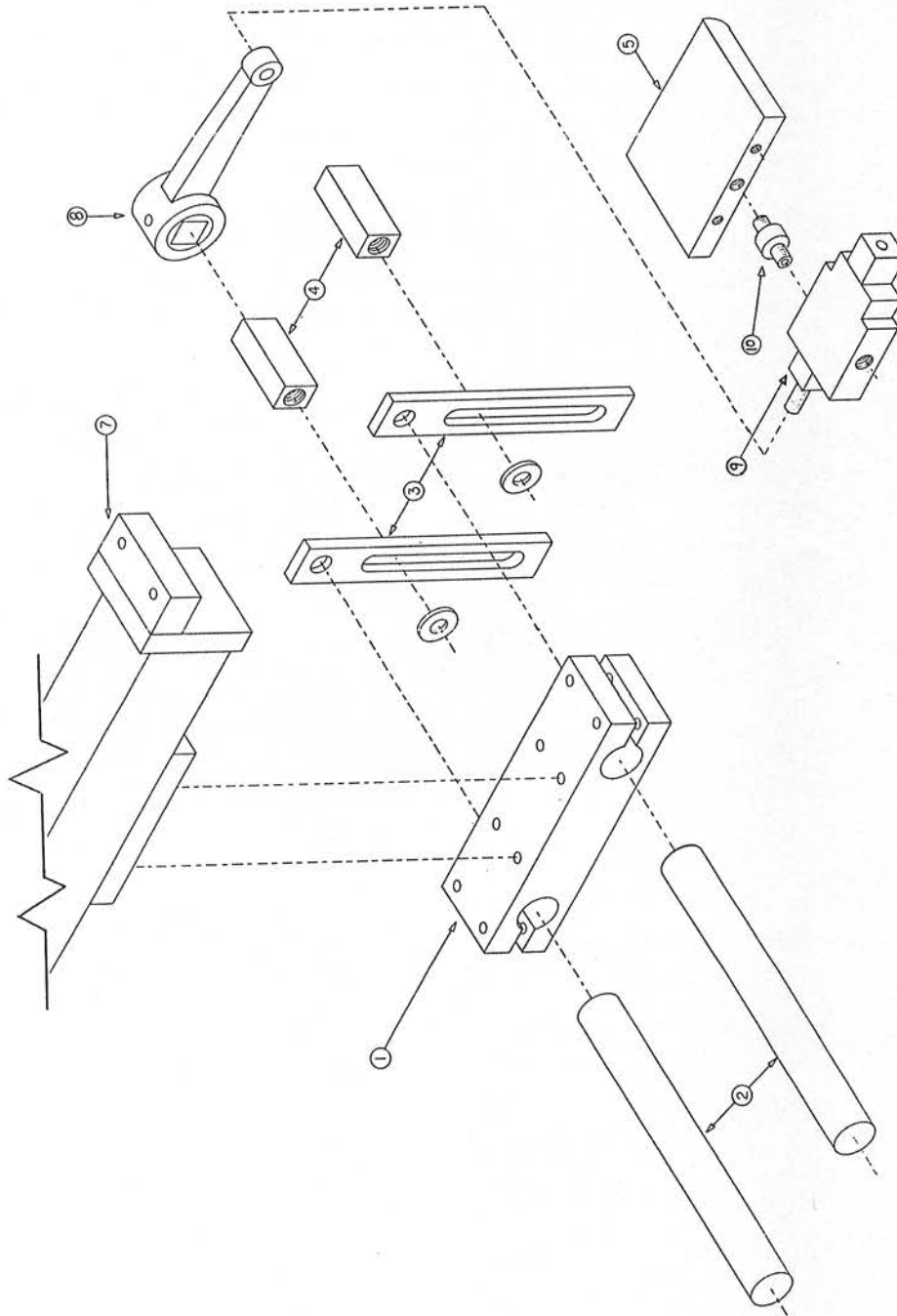

LINER GLUE APPLICATOR

DWG NO. 451001

SCALE: NTS DATE: 01/97

REF NO	PART NO	QTY	PART NAME
1	45P010-A	6	FOLDER ARM
2	45P011-A	6	FOLDER ARM EXTENSION
3	45P012-A	6	FOLDER ARM ROLLER
6	45P015-A	1	RETURN CAM
7	43P113-A	1	1 3/4" 4 HOLE FLANGE BEARING
8	45P016-A	1	FOLDER ARM SHAFT
9	45P132-A	2	ROTARY ACTUATOR, DOUBLE
10	45P017-A	8	UPPER CARRIAGE MOUNT SHAFT
10	45P018-A	8	ECCENTRIC LOWER CARRIAGE MOUNT SHAFT
12	45P005-A	16	STATIONARY ROLLER
13	45P180-A	16	1 1/2" OD X 3/16" WASHER
14	45P020-A	2	VACUUM CARRIAGE
15	45P021-A	6	VACUUM TRAY
16	45P019-A	2	1 3/4" OD X 1/4" WASHER



CRITTENDEN
CONVERSION
CORPORATION

FOLDER-VACUUM CARRIAGE ASSY

DWG NO. 451002

SCALE: NTS/DATE: 01/97

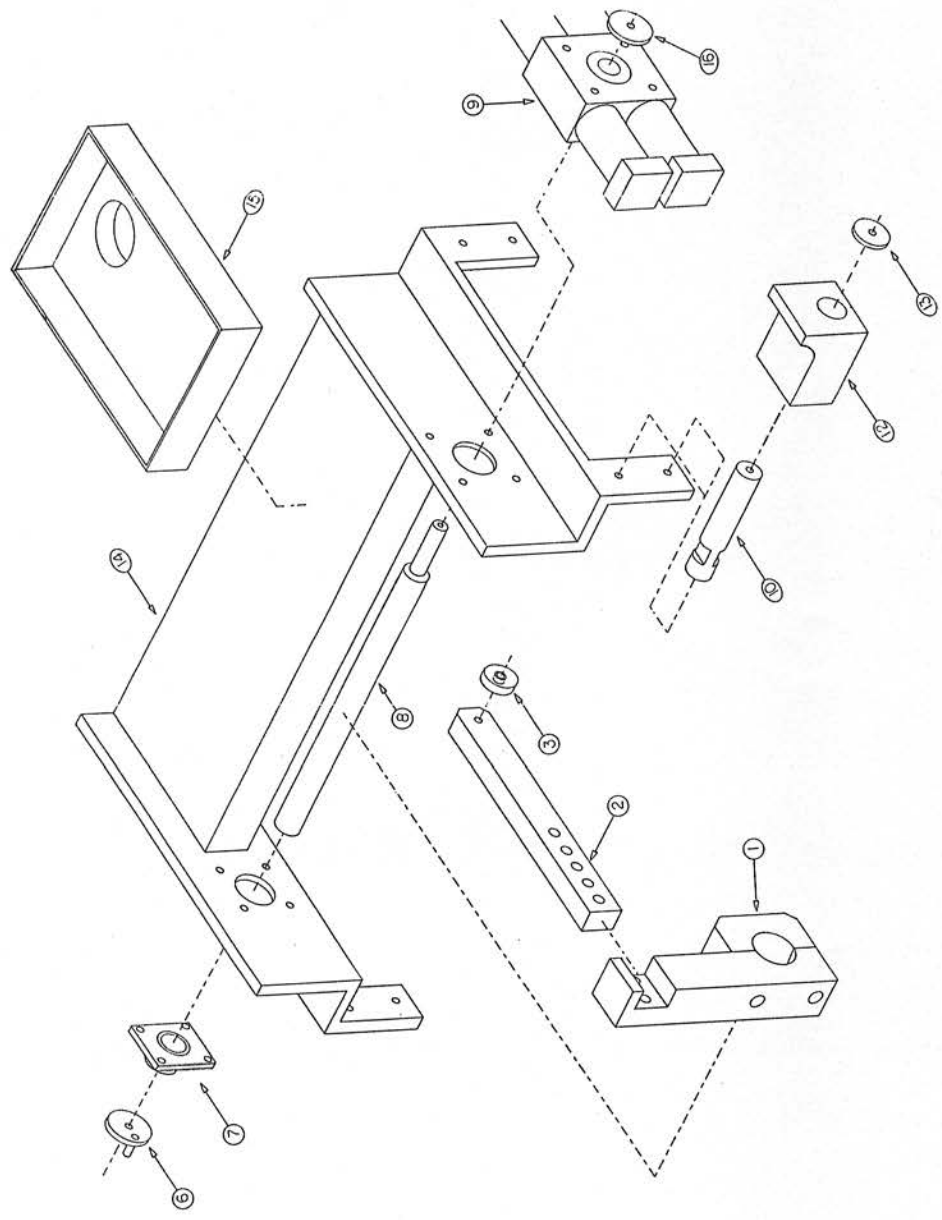

REF NO	PART NO	QTY	PART NAME	DWG
01	43P113-A	4	1 3/4" 4 HOLE FLANGE BEARING	45I003
02	43P114-A	1	1 3/4" TAP BASE BEARING	45I003
03	41P063-A	1	1" X 1 1/8" LOVEJOY COUPLING, 100	45I003
04	47P036-A	1	HYDRAULIC MOTOR	45I003
05	44P022-A	1	GLUE TRAY	45I003
06	45P102-A	6	6" SPLIT CROWN PULLEY	45I003
07	45P131-A	1	RODLESS CYLINDER	45I003
08	45P024-A	1	28" 1 3/4" PULLEY SHAFT	45I003
09	45P025-A	1	DRIVEN PULLEY SHAFT	45I003
10	45P119-A	1	RODLESS CYL, ARCH	45I003
11	45P089-A	1	CONDUFLEX	45I003
12	45P086-A	1	ACCUATOR, SINGLE	45I003
13	45P083-A	1	ACCUATOR ARM SUPPORT	45I003
14	45P124-A	1	FLAP ARM	45I003
15	45P087-A	2	1 1/2" X 1" AIR CYLINDER	45I003
17	45P081-A	1	CENTER MOUNT	45I003
18	44P041-A	3	WEIGHT WHEEL	45I003
19	45P023-A	1	BEARING SUPPORT ARM	45I003
20	45P096-A	1	1 1/2" 2 HOLE FLANGE BEARING	45I003

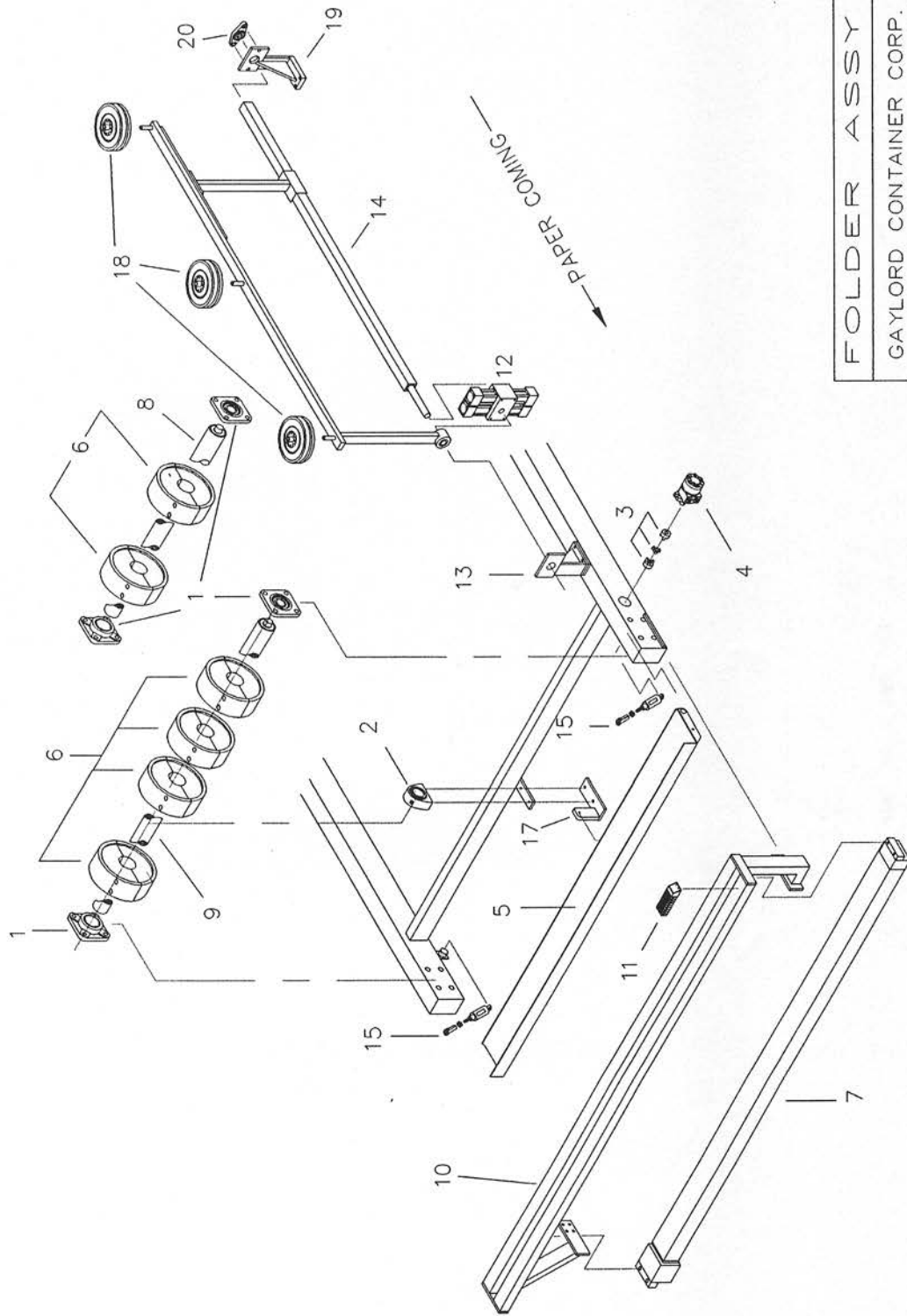

 CRITTENDEN CONVERSION CORPORATION	
FOLDER ASSY	
GAYLORD CONTAINER CORP.	
DWG NO. 451003	
SCALE: NTS(1=1)	DATE: 10/97
EDIT: 4/23/98	

REF NO	PART NO	QTY	PART NAME	DWG
01	43P113-A	4	1 3/4" 4 HOLE FLANGE BEARING	451003
02	43P114-A	1	1 3/4" TAP BASE BEARING	451003
03	41P063-A	1	1" X 1 1/8" LOVEJOY COUPLING,100	451003
04	47P036-A	1	HYDRAULIC MOTOR	451003
05	45P080-A	1	DROP TRAY	451003
06	45P102-A	6	6" SPLIT CROWN PULLEY	451003
07	45P131-A	1	RODLESS CYLINDER	451003
08	45P024-A	1	28" 1 3/4" PULLEY SHAFT	451003
09	45P025-A	1	DRIVEN PULLEY SHAFT	451003
10	45P119-A	1	RODLESS CYL SUPPORT	451003
11	45P089-A	1	CONDUFLEX	451003

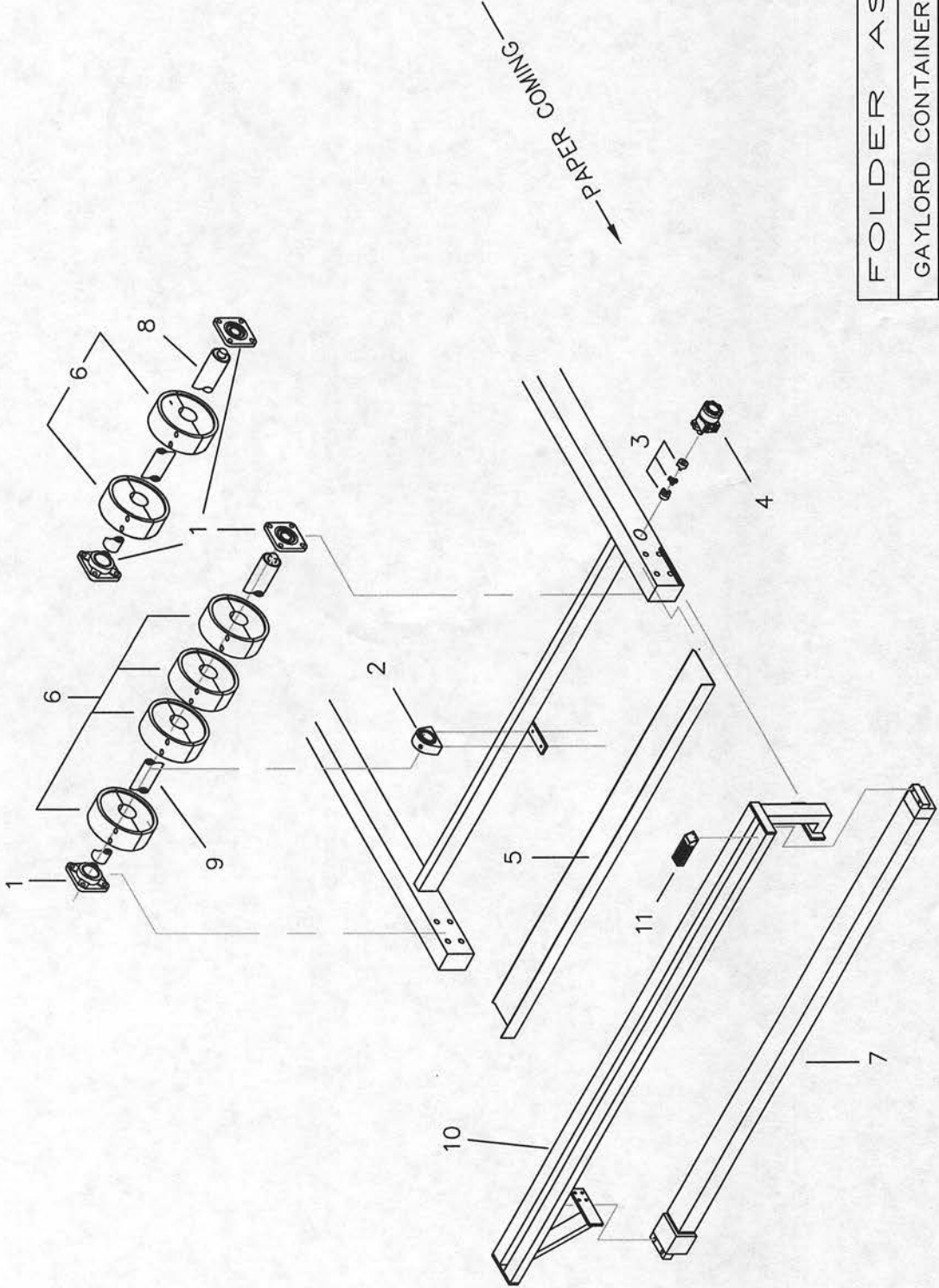

FOLDER ASSY
GAYLORD CONTAINER CORP.
DWG NO. 451003S
SCALE: NTS(1=1) DATE: 10/97 EDIT: 4/23/98



REF NO	PART NO	QTY	PART NAME	DWG
1	45P026-A	2	OFFFEED WHEEL SLIDING HEAD	45I004
2	45P027-A	8	OFFFEED WHEEL SLIDING HEAD INSERT	45I004
3	45P028-A	2	STAR KNOB	45I004
4	45P015-A	2	RETURN CAM	45I004
5	45P154-A	1	1 7/16" 2 HOLE FLANGE BEARING	45I004
6	45P086-A	1	ROTORY ACTUATOR	45I004
7	45P029-A	1	ADJUSTMENT BOLT	45I004
8	45P019-A	1	1 3/4" X 1/4" WASHER	45I004
9	45P151-A	2	DRIVE BELT	45I004
10	45P155-A	4	DRIVE BELT PULLEY	45I004
11	45P030-A	2	HYDRAULIC MOTOR MOUNT	45I004
12	45P153-A	4	BEARING	45I004
13	45P103-A	2	FEED ROLL	45I004
14	45P031-A	2	SHAFT	45I004
15	45P032-A	1	PIVOT SHAFT	45I004
16	45P182-A	1	DRIVEN BELT PULLEY	45I004
17	43P040-A	1	HYDRAULIC MOTOR	45I001

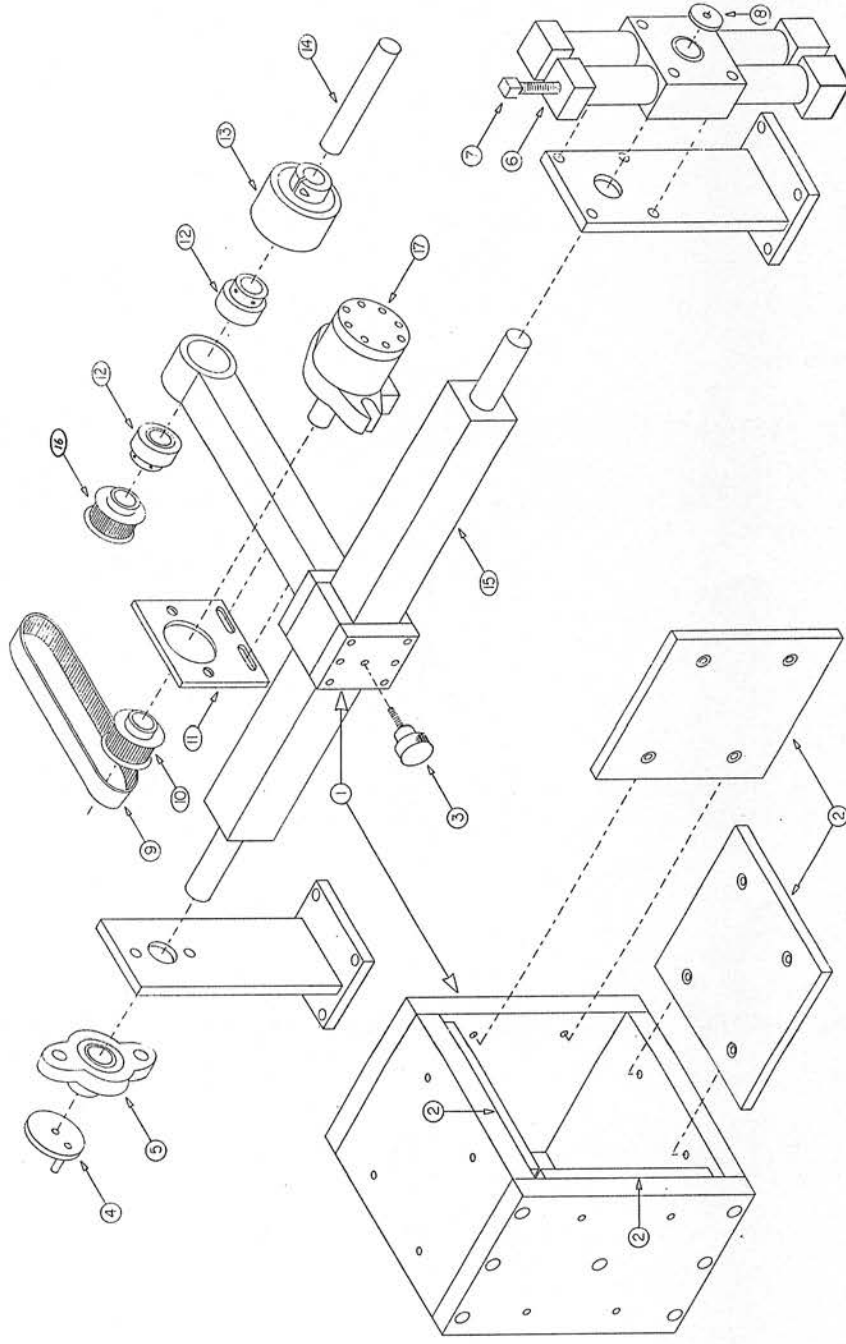

FOLDER
451004-A
 C4000 DATE: 03/06/96
 BULK BIN LAMINATOR 4500D

REF NO	PART NO	QTY	PART NAME	DWG
1	45P033-A	1	UPPER PULL ROLL SHAFT	45I005
2	45P034-A	1	LOWER PULL ROLL SHAFT	45I005
3	45P035-A	8	PULL ROLL	45I005
4	43P114-A	6	1 3/4" TAP BASE BEARING	45I005
6	46P062-A	2	LOVEJOY COUPLING, 90	45I005
7	43P040-A	2	HYDRAULIC DRIVE MOTOR	45I005
8	45P036-A	4	WEAR PLATE	45I005
9	45P183-A	2	AIR CYLINDER	45I005
10	45P148-A	2	CYLINDER FLOW CONTROL	45I005
11	44P115-A	2	ROD END	45I005

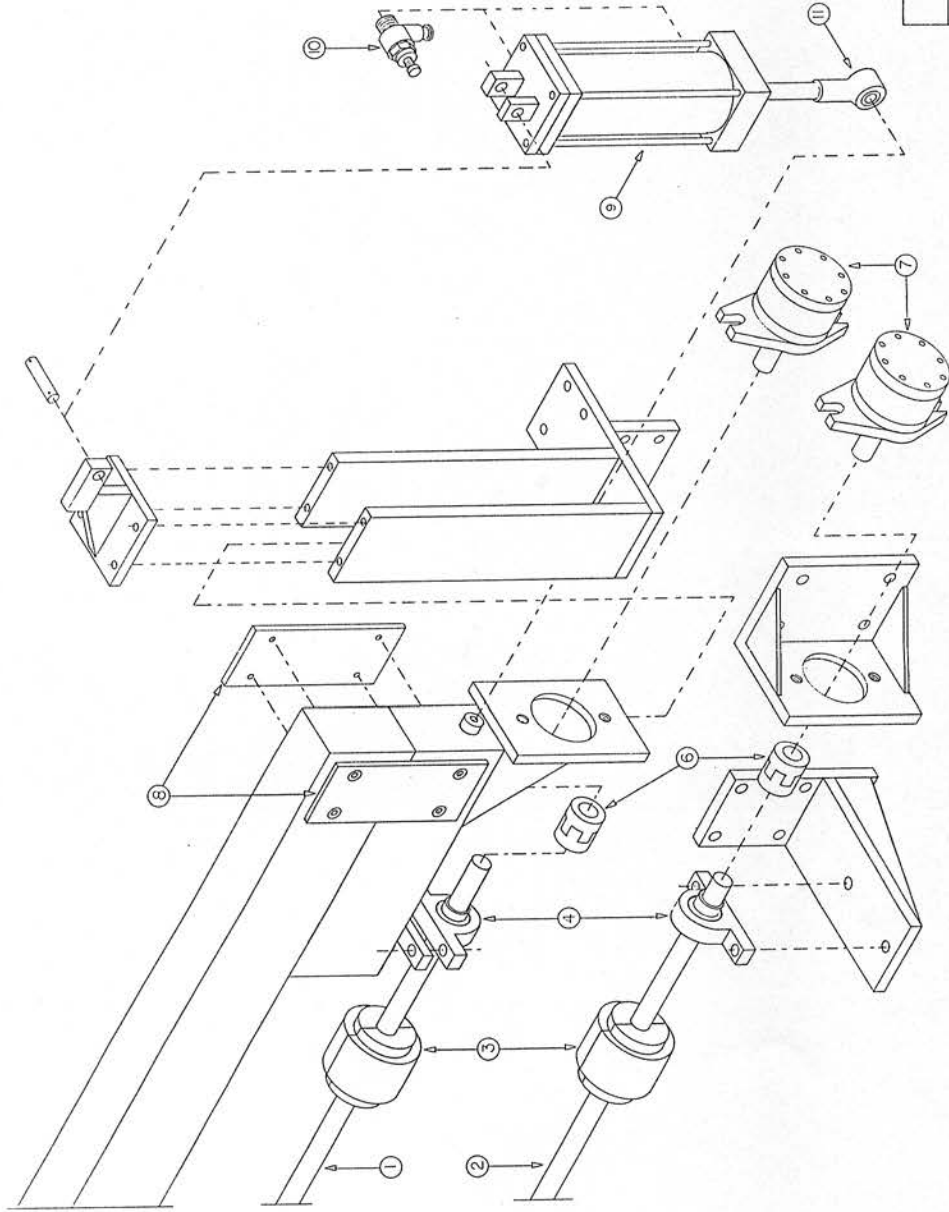

FOLDER

451005-A

C4000 DATE: 03/06/96

BULK BIN LAMINATOR 4500E

REF NO	PART NO	QTY	PART NAME	DWG
1	45P037-A	6	LIFTING ARM	451006
2	45P038-A	12	LIFTING ARM BUSHING	451006
3	45P149-A	6	RUBBER ROLL	451006
4	45P150-A	12	BEARING	451006
5	44P087-A	2	AIR CYLINDER	451006
6	44P115-A	2	ROD END	451006
7	45P039-A	2	LIFTING ARM BODY	451006
8	45P040-A	2	STATIONARY LIFTING ARM BODY	451006
9	45P021-A	6	VACUUM TRAY	451006
10	44P122-A	1	PIN	451006
11	44P121-A	1	CLEVIS	451006

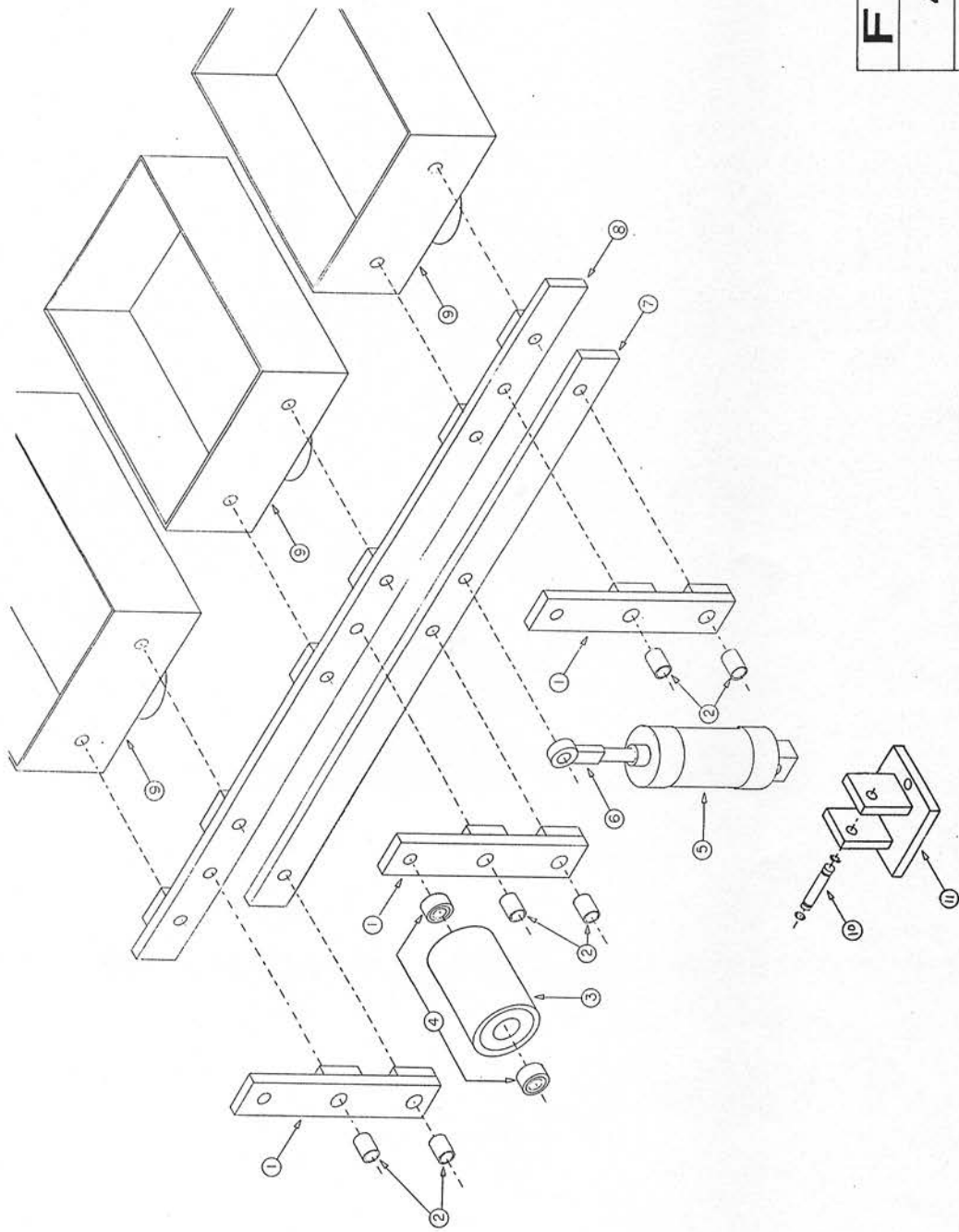

FOLDER
451006-A
C4000 DATE: 03/06/96
BULK BIN LAMINATOR 4500F

REF NO	PART NO	QTY	PART NAME	DWG
01	45P135-A	2	TORQUE LIMITER	451007
01A	45P136-A	2	HUB	451007
01B	45P137-A	2	CLUTCH DISK	451007
01C	45P138-A	2	SPROCKET	451007
01D	45P139-A	2	BUSHING	451007
01E	45P140-A	2	WEAR PLATE	451007
01F	45P137-A	2	CLUTCH DISK	451007
01G	45P141-A	2	SPRING WASHER	451007
01H	45P142-A	2	LOCK NUT	451007
02	45P109-A	2	CHAIN	451007
03	45P105-A	2	16T SPROCKET	451007
04	45P106-A	2	SHAFT	451007
05	45P107-A	4	RACK GEAR	451007
06	45P108-A	4	RACK	451007
07	41P065-A	4	3 HOLE FLANGE BEARING	451007
08	45P143-A	2	MOTOR, SPECIFY RIGHT OR LEFT	451007

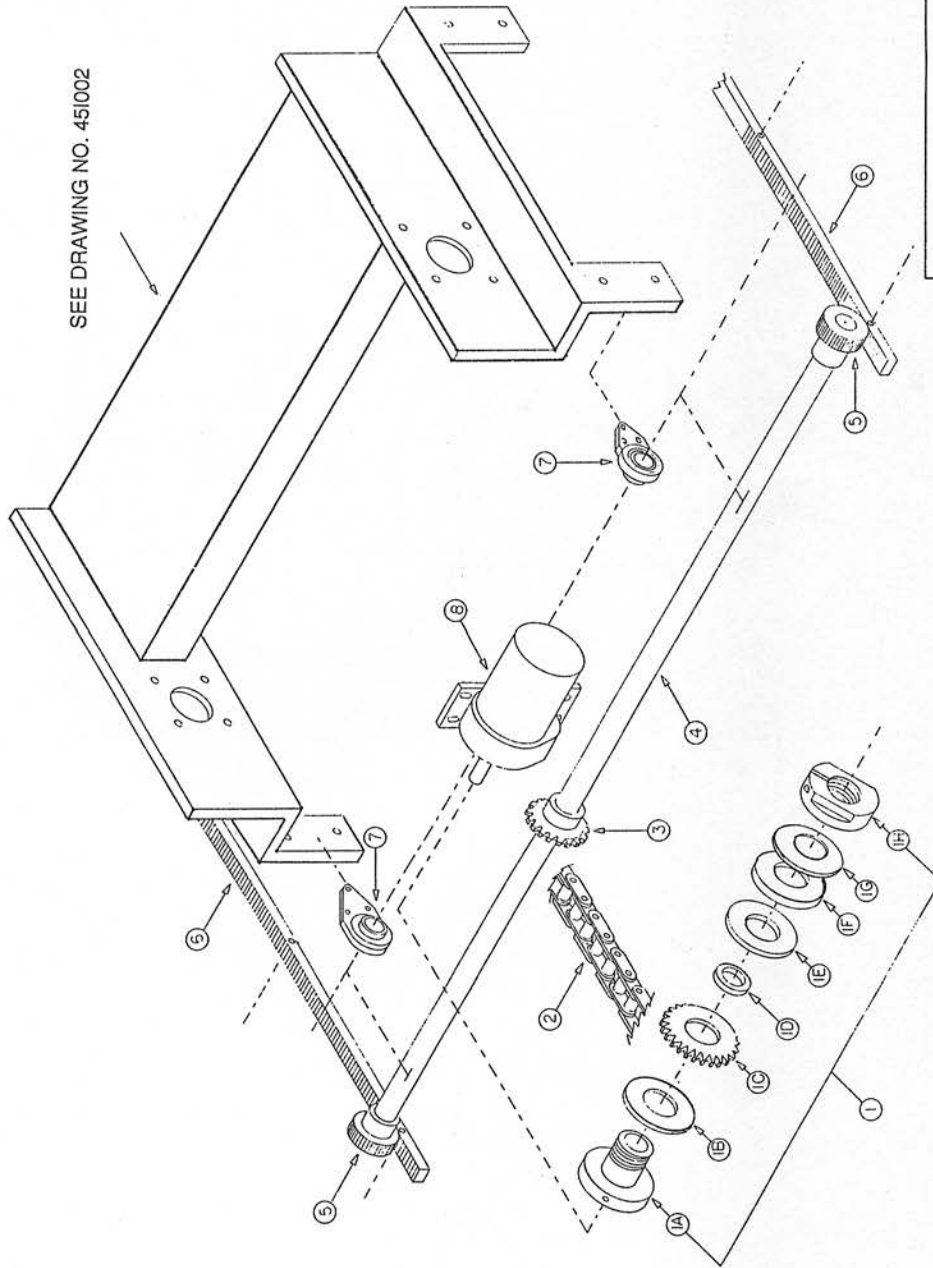

SEE DRAWING NO. 451002



CRITTENDEN
CONVERSION
CORPORATION

FOLDER-VACUUM DRIVE ASSY	
DWG NO. 451007	
SCALE: NTS	DATE: 01/97

REF NO	PART NO	QTY	PART NAME	DWG
1	45P144-A	1	BLOWER MOTOR	45I008
2	45P046-A	1	EXHAUST MUFFLER	45I008
3	45P145-A	1	HOUSING	45I008
4	45P047-A	1	IMPELLER	45I008
5	45P145-A	1	BASE PLATE	45I008
6	45P048-A	1	MANIFOLD	45I008
7	45P146-A	2	5/8" 2 HOLE FLANGE BEARING	45I008
8	45P049-A	1	BASE FRAME	45I008
9	45P050-A	1	BUTTERFLY SHAFT	45I008
10	45P051-A	1	BUTTERFLY	45I008
11	45P052-A	1	LEVER	45I008
12	44P115-A	1	ROD END	45I008
13	44P087-A	1	2 X 2 AIR CYLINDER	45I008
14	44P124-A	1	PIN	45I008
15	44P121-A	1	CLEVIS	45I008
16	45P094-A	1	1 1/16" X 1" AIR CYLINDER	45I008



CRITTENDEN
CONVERSION
CORPORATION

FOLDER-BLOWER ASSY

DWG NO. 451008

SCALE: NTS | DATE: 01/97

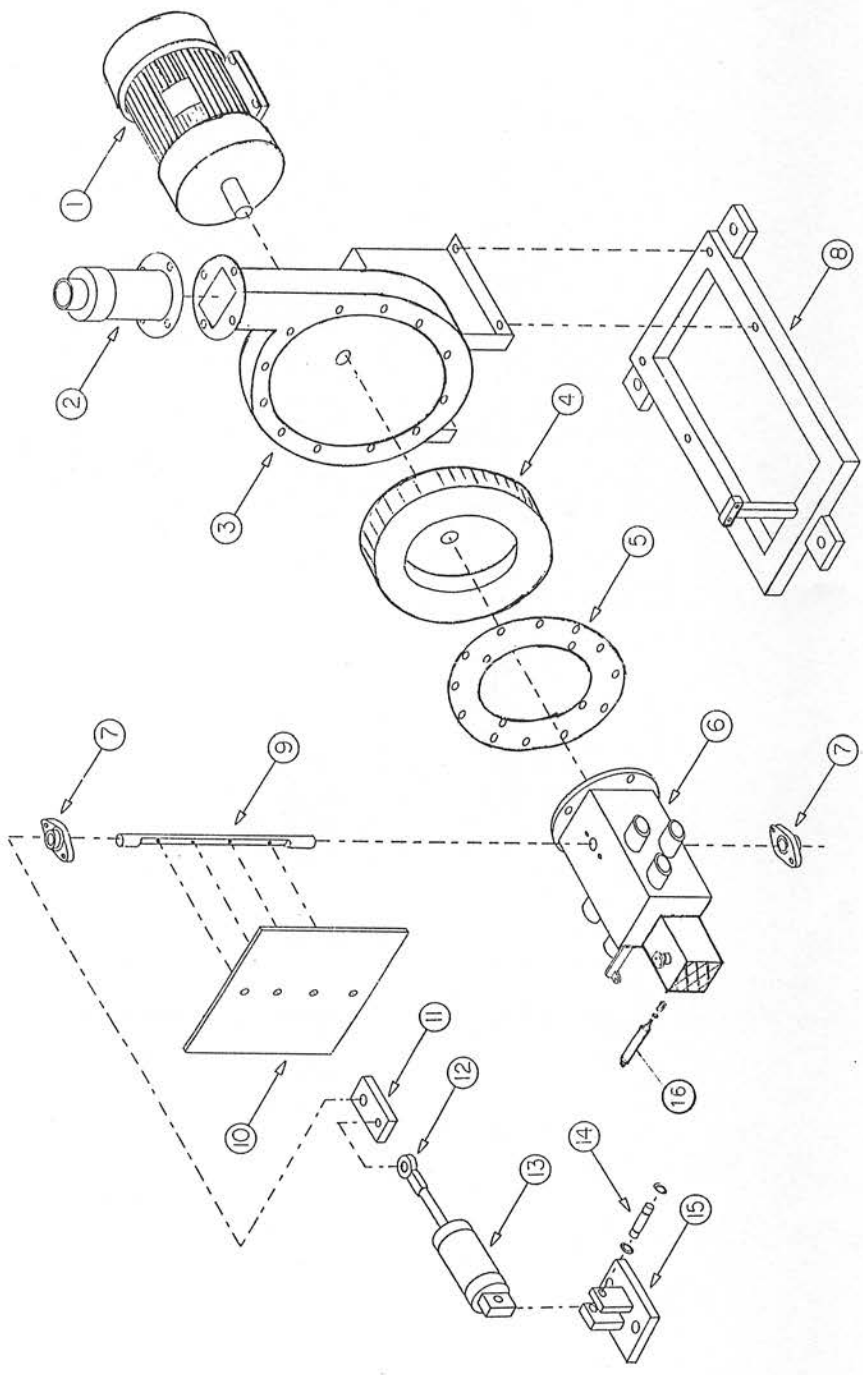

REF NO	PART NO	QTY	PART NAME	DWG
01	46P057-A	20	PIN	46I001
02	46P058-A	20	CLEVIS/PIN SET	46I001
03	46P059-A	20	AIR CYLINDER-2.5 X 6	46I001
03	46P063-A	1	SEAL REPAIR KIT FOR 46P059-A	46I001
04	43P040-A	5	HYDRAULIC MOTOR	46I001
05	46P102-A	80	4" SPLIT CROWN PULLEY	46I001
06	46P061-A	20	1 1/8" 3 HOLE FLANGE BEARING	46I001
07	43P003-A	15	COMPRESSION PAD	46I001
08	46P062-A	5	LOVEJOY COUPLING. 90	46I001
09	46P022-A	5	1 1/8" DRIVEN PULLEY SHAFT	46I001
10	46P023-A	5	1 1/8" IDLER PULLEY SHAFT	46I001

PLATEN PRESS

DWG NO. 461001

SCALE: NTS DATE: 01/97

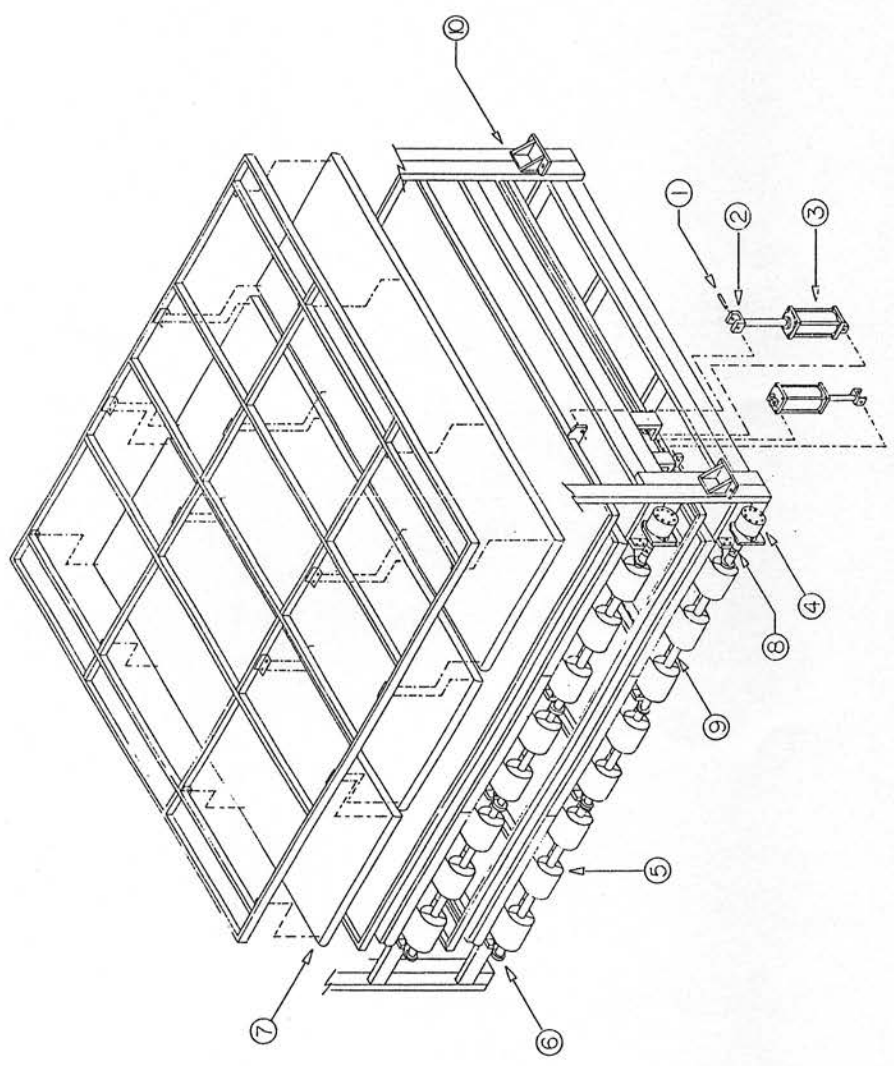
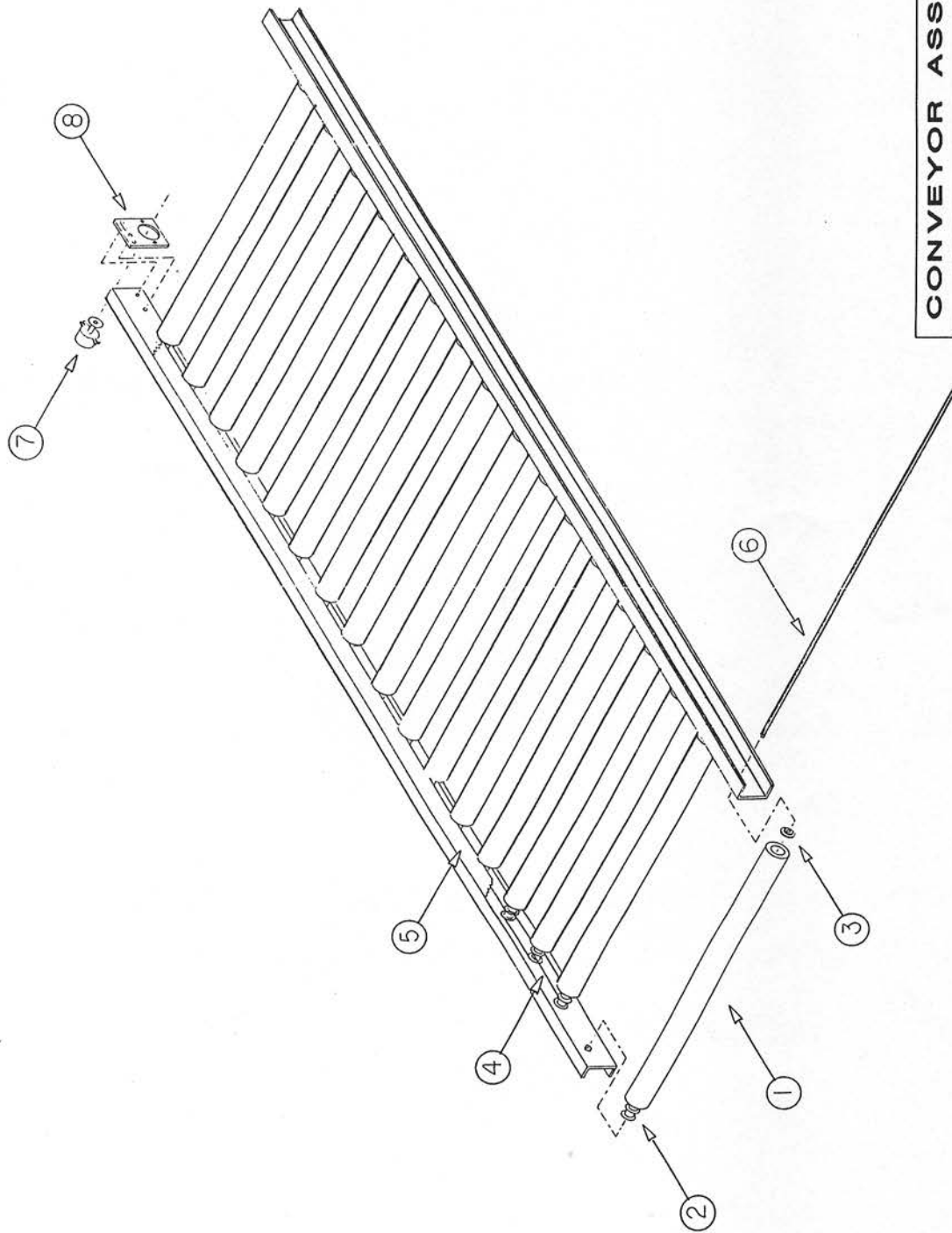



TABLE CONVEYOR-47I001

5/8/98

REF NO	PART NO	QTY	PART NAME	DWG
1	47P001-A	40	DRIVEN ROLLER	47I001
2	47P103-A	40	DOUBLE SPROCKET	47I001
3	47P106-A	40	BEARING	47I001
4	47P107-A	40	CHAIN	47I001
5	47P006-A	2	GUARD	47I001
6	47P003-A	40	HEX SHAFT	47I001
7	45P039-A	1	HYDRAULIC MOTOR	47I001
8	47P004-A	1	MOTOR MOUNT	47I001



 CRITTENDEN CONVERSION CORPORATION	
CONVEYOR ASSY	
DWG NO. 471001	
SCALE: NTS DATE: 01/97	

REF NO	PART NO	QTY	PART NAME	DWG
01	48P061-A	6	1/4" PORT FLR	48I001
03	48P063-A	8	REFLECTOR 1 1/2" OD	48I001
04	48P064-A	10	PHOTO EYE / REFLECTIVE	48I001
04A	48P065-A	10	PHOTO EYE/ NON-REFLECTIVE	48I001
05	48P066-A	16	PHOTO EYE CABLE	48I001
06	48P067-A	12	PHOTO EYE BRACKET	48I001
07	48P068-A	16	SMC SOLENOID	48I001
08	48P069-A	11	SMC MINI REGULATOR 1/4 PORT	48I001
09	48P062-A	11	1/4 PORT GAUGE	48I001
10	48P070-A	11	BRACKET	48I001
11	48P071-A	2	REED SWITCH	48I001
12	48P072-A	2	REED SWITCH BRACKET	48I001
13	48P073-A	2	(MAC) SOLENOID VALVE	48I001

ELECTRICAL & PNEUMATICS (TYP)

DWG NO. 481001

SCALE: NTS|DATE:01/97

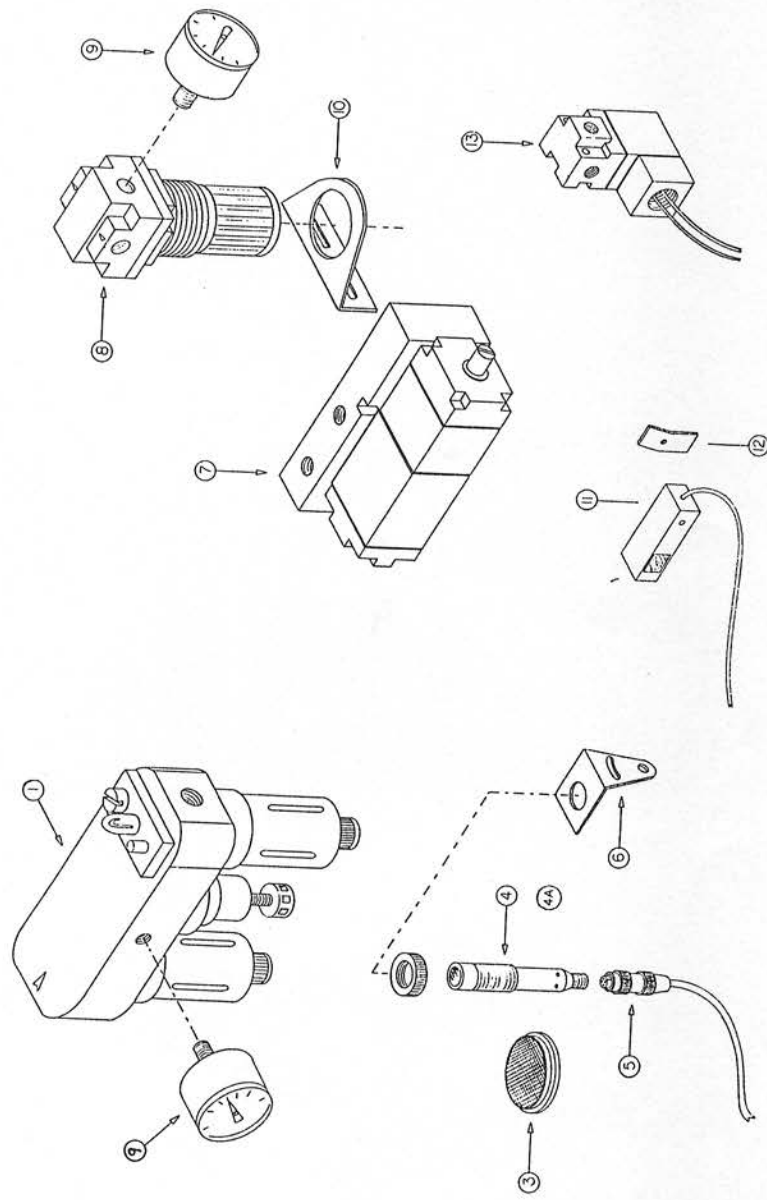
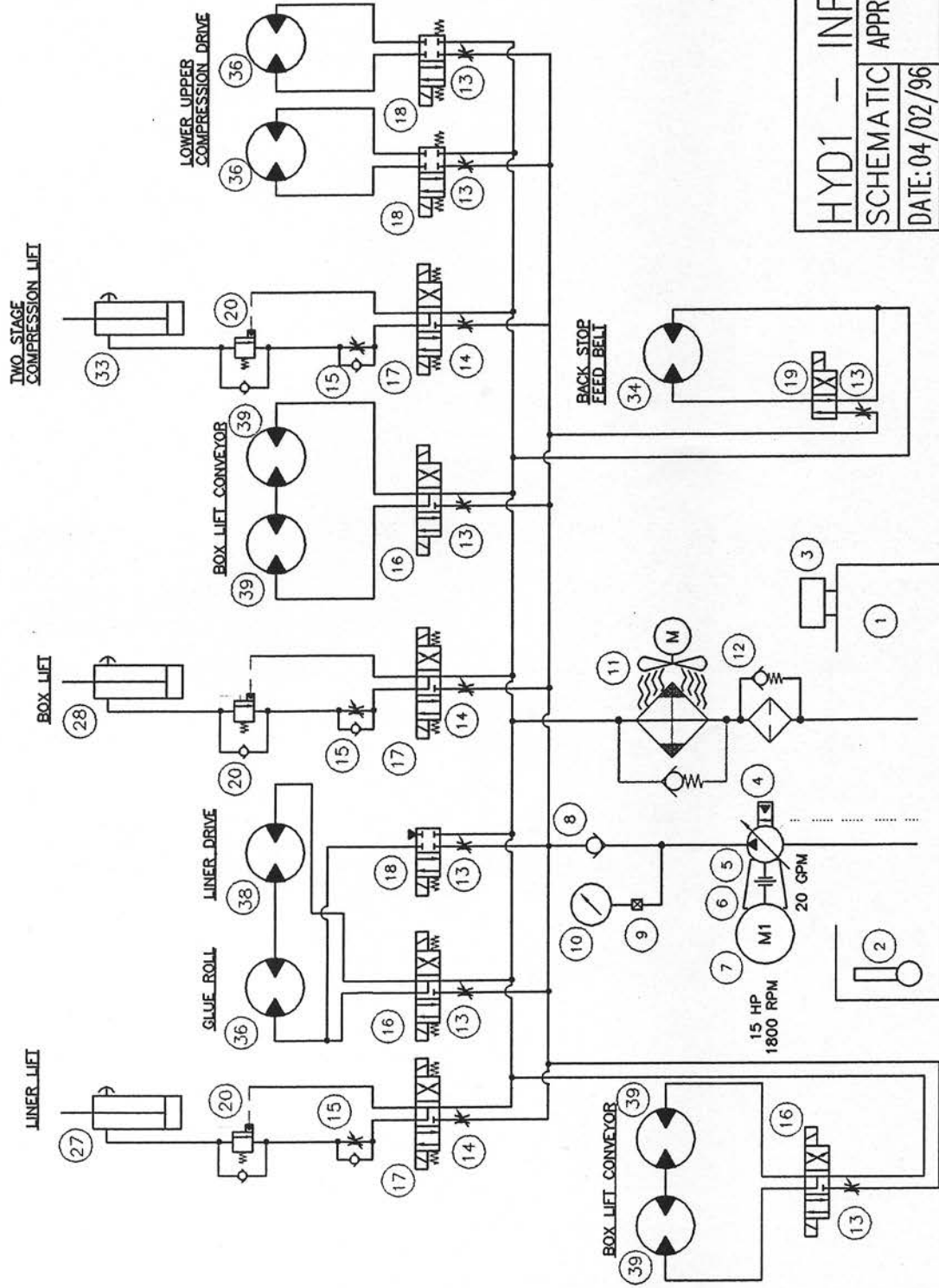

TABLE SYSTEMS/HYD1-GLUER

5/8/98

REF NO	PART NO	QTY	PART NAME
1	48P001-A	1	RESERVOIR
2	48P002-A	1	SIGHT GAUGE
3	48P003-A	1	FILLER BREATHER
4	48P004-A	1	PUMP
5	48P005-A	1	PUMP MOUNT
6	48P006-A	1	COUPLING
7	48P007-A	1	ELECTRIC MOTOR
8	48P008-A	1	CHECK VALVE
9	48P009-A	1	GAUGE SNUBBER
10	48P010-A	1	GAUGE
11	48P011-A	1	HEAT EXCHANGER
11A	48P012-A	1	TEMPERATURE SWITCH
12	48P013-A	1	RETURN FILTER
13	48P014-A	7	FLOW CONTROLS
14	48P015-A	3	FLOW CONTROLS
15	48P016-A	3	FLOW CONTROLS
16	48P017-A	3	4-WAY VALVES
17	48P018-A	3	4-WAY VALVES
18	48P019-A	3	4-WAY VALVES
19	48P020-A	1	4-WAY VALVES
20	48P021-A	3	COUNTER BALANCE VALVES
27	40P071-A	1	LINER LIFT CYLINDER, 5 X 32
28	40P072-A	1	BOX LIFT CYLINDER, 6 X 32
33	40P073-A	1	12-STATION LIFT CYLINDER, 6 X 9
34	43P040-A	3	HYDRAULIC MOTOR
36	47P036-A	1	HYDRAULIC MOTOR
38	42P115-A	1	HYDRAULIC MOTOR
39	47P039-A	4	HYDRAULIC MOTOR



HYD1 - INFEED SECTION
 SCHEMATIC APPROVED BY: 
 DATE: 04/02/96
 REDRAWN: / /
CRITTENDEN CONVERSION CORP.
 BULK BIN C4000 LAMINATOR DWG # 48L002-A
 HYDRAULIC POWER UNIT HYD1 OLD DWG 771

60 GALLON RESERVOIR

TABLE SYSTEMS/HYD2-SCORE

5/8/98

REF NO	PART NO	QTY	PART NAME
1	48P022-A	1	40 GAL RESERVOIR
2	48P002-A	1	SIGHT GAGE
3	48P003-A	1	FILLER BREATHER
4	48P004-A	1	PUMP
5	48P005-A	1	PUMP MOUNT
6	48P006-A	1	COUPLING
7	48P023-A	1	ELECTRIC MOTOR
8	48P024-A	1	CHECK/ACCUMULATOR BLEED
9	48P025-A	1	ACCUMULATOR
10	48P009-A	1	GAUGE SNUBBER
11	48P010-A	1	GAUGE
12	48P013-A	1	RETURN FILTER
13	48P026-A	1	HEAT EXCHANGER
14	48P027-A	2	4-WAY VALVE
15	48P021-A	2	COUNTER BALANCE VALVES
26	44P124-A	4	SCORE CYLINDER

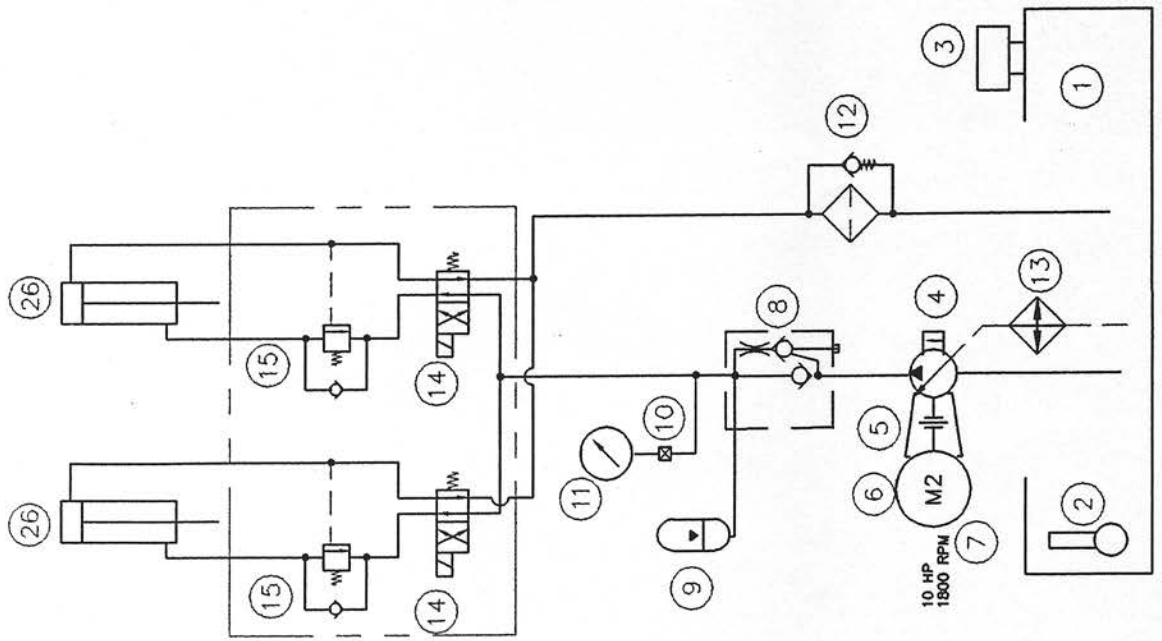

40 GALLON RESERVOIR

HYD2 - SCORE SECTION

SCHEMATIC APPROVED BY:  DRAWN BY: 

DATE: 04/02/96 REDRAWN: / /

CRITTENDEN CONVERSION CORP.

BULK BIN C4000 LAMINATOR DWG # 48L004-A

HYDRAULIC POWER UNIT HYD2 OLD DWG 773

TABLE SYSTEMS/HYD3-FOLDER

5/8/98

REF NO	PART NO	QTY	PART NAME
1	48P001-A	1	60 GALLON RESERVOIR
2	48P002-A	1	SIGHT GAUGE
3	48P003-A	1	FILLER BREATHER
4	48P004-A	1	PUMP
5	48P005-A	1	PUMP MOUNT
6	48P006-A	1	COUPLING
7	48P007-A	1	ELECTRIC MOTOR
8	48P024-A	1	CHECK/ACCUMULATOR BLEED
9	48P009-A	1	GAUGE SNUBBER
10	48P010-A	1	GAUGE
11	48P025-A	1	ACCUMULATOR
12	48P026-A	1	HEAT EXCHANGER
12A	48P012-A	1	TEMPERATURE SWITCH
13	48P013-A	1	RETURN FILTER
14	48P014-A	5	FLOW CONTROLS
15	48P015-A	2	FLOW CONTROLS
16	48P028-A	1	FLOW CONTROLS
17	48P029-A	1	4-WAY VALVE
18	48P020-A	6	4-WAY VALVE
19	48P018-A	2	4-WAY VALVE
20	48P030-A	4	2-WAY VALVE
21	48P031-A	6	FLOW CONTROLS
22	48P032-A	1	PRESSURE REDUCING
23	48P021-A	2	COUNTER BALANCE VALVES
24	48P034-A	3	CHECK VALVES
25	48P016-A	2	FLOW CONTROL
29	40P074-A	1	HYDRAULIC CYLINDER
30	45P132-A	1	HYDRAULIC ACCUATOR
31	45P086-A	1	HYDRAULIC ACCUATOR
32	48P034-A	1	LIFT CYLINDER
34	43P040-A	5	HYDRAULIC MOTOR
36	47P036-A	1	HYDRAULIC MOTOR
37	47P039-A	1	HYDRAULIC MOTOR

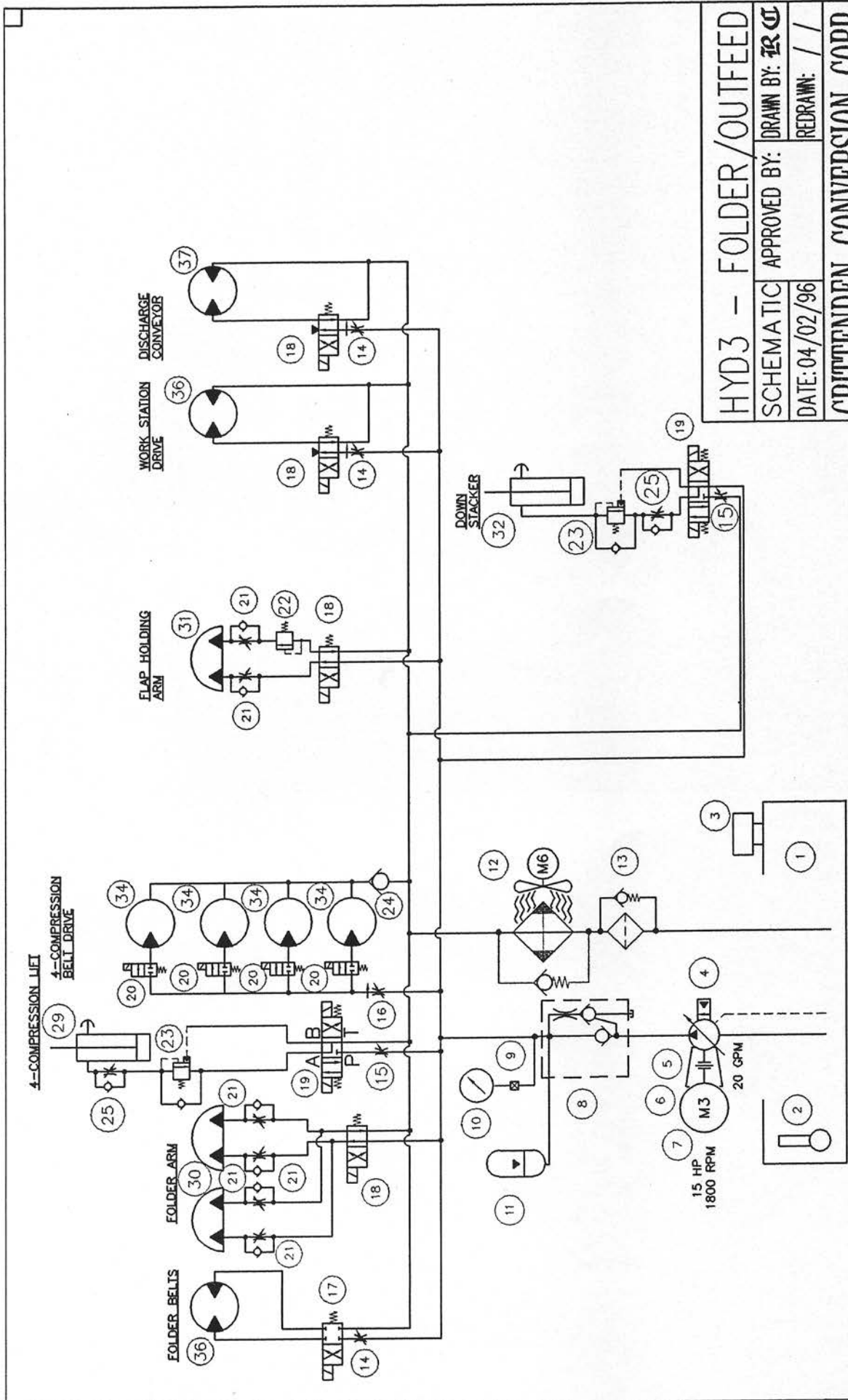

HYD3 - FOLDER/OUTFEED	
SCHEMATIC APPROVED BY:	DRAWN BY: TRC
DATE: 04/02/96	REDRAWN: / /
CRITTENDEN CONVERSION CORP.	
BULK BIN C4000 LAMINATOR	DWG # 48L003-A
HYDRAULIC POWER UNIT HYD3	OLD DWG 772

60 GALLON RESERVOIR